

MEETINGS AT 165

Discover our newly refreshed meeting spaces & guestrooms



Full Day Meeting Package	Half Day Meeting Package	Half Day Meeting Package <i>(without lunch)</i>
<p>S\$ 110++ per person (2 coffee breaks & lunch) (U.P. S\$125++)</p>	<p>S\$ 95++ per person (1 coffee break & lunch) (U.P. S\$105++)</p>	<p>S\$ 75++ per person (1 coffee break) (U.P. S\$85++)</p>

All meeting participants can submit their business cards to enter a lucky draw valid until August 31st, with a chance to win a 3D2N stay with us.

- Usage of the private meeting rooms for stipulated duration
- Free flow of coffee and tea throughout the meeting duration
- Coffee/tea breaks (3 snack items per break)
- Use of one flipchart with assorted markers
- Writing materials and pens, drinking water and mints
- Complimentary usage of laser projector and screen (one unit)
- Complimentary usage of Wireless Microphone (one unit)
- Complimentary WIFI for all guests

FLOOR PLAN

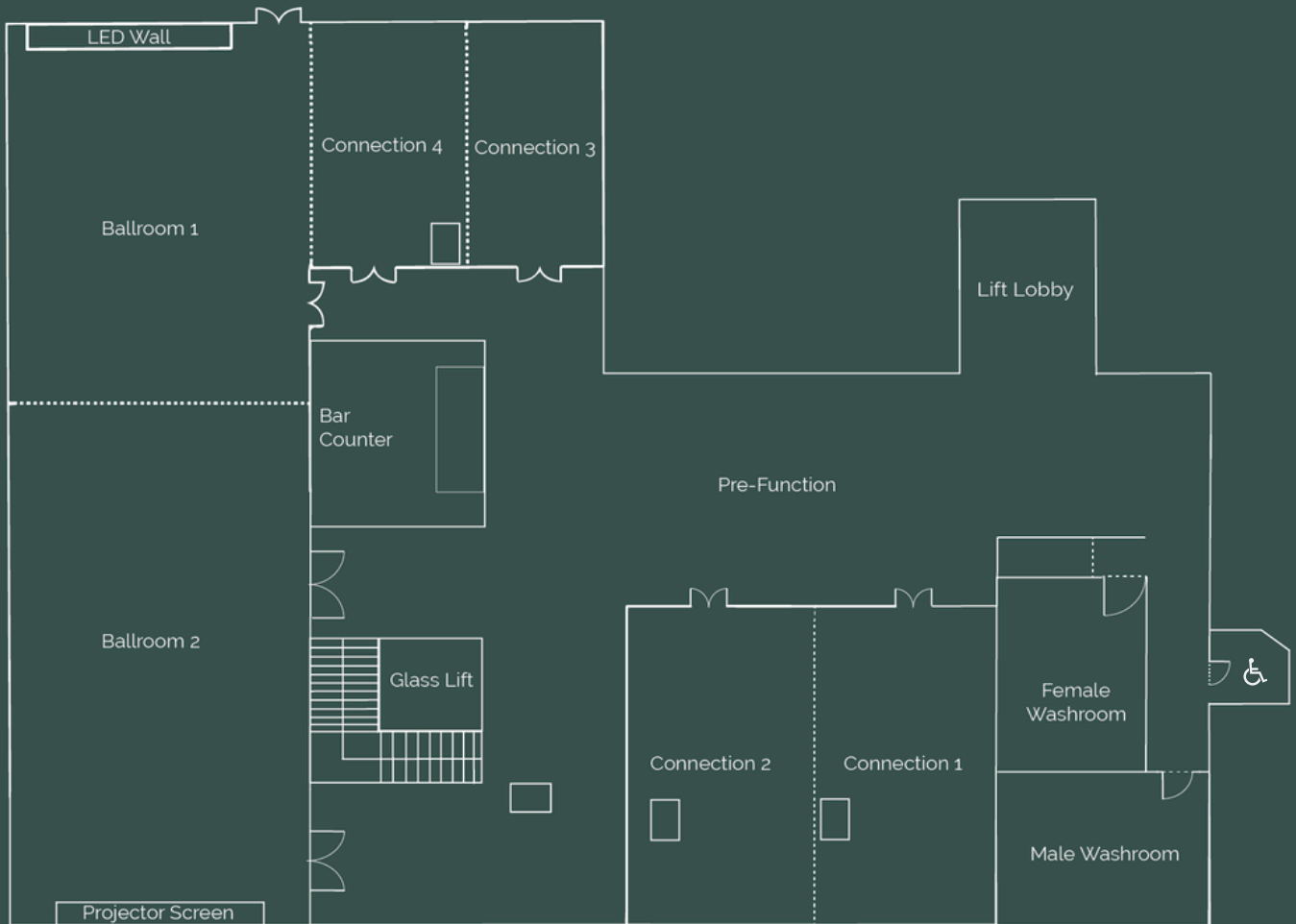

CAPACITY CHART

<p>GRAND BALLROOM</p> <p>Maximum</p> <p>500</p> <p>Theatre Seating 666 sqm</p>	<p>BALLROOM 1/2</p> <p>Maximum</p> <p>400</p> <p>Theatre Seating 510 sqm</p>	<p>CONNECTION 1</p> <p>Maximum</p> <p>60</p> <p>Theatre Seating 102 sqm</p>	<p>CONNECTION 2</p> <p>Maximum</p> <p>60</p> <p>Theatre Seating 108 sqm</p>	<p>CONNECTION 3</p> <p>Maximum</p> <p>50</p> <p>Theatre Seating 74 sqm</p>	<p>CONNECTION 4</p> <p>Maximum</p> <p>50</p> <p>Theatre Seating 82 sqm</p>
---	---	--	--	---	---