

FACT SHEET

WOW CONVENTION CENTER



wow

ISTANBUL
Hotels & Convention Center

WOW CONVENTION CENTER

Address : WOW Convention Center Yeşilköy Mahallesi
Atatürk Caddesi 34149

No: 15-17-19 Bakırköy / İstanbul

Tel : 00 90 212 468 50 00

Fax : 00 90 212 465 06 75

Website : www.wowhotelsistanbul.com

E-mail : info@wowhotelsistanbul.com

Social Media Accounts : [Facebook.com/wowistanbul](https://www.facebook.com/wowistanbul)

[Twitter.com/wowistanbul](https://twitter.com/wowistanbul)

[Instagram.com/wowistanbul](https://www.instagram.com/wowistanbul)

[Linkedin.com/company/wowistanbul](https://www.linkedin.com/company/wowistanbul)

[Foursquare.com/wowistanbul](https://www.foursquare.com/wowistanbul)

[Vk.com/wowistanbul](https://www.vk.com/wowistanbul)

[Youtube.com/wowistanbul](https://www.youtube.com/wowistanbul)

Category : A Block May 2007

Date of Construction : May 2007

Total Area : 15.573 m²

Meeting Area : 5.107m²

Valid Credit Cards : Amex, Diners, Visa, Master

Working Hours : Weekdays 08:30 - 18:00

Saturday 09:00 - 14:00



wow

ISTANBUL
Hotels & Convention Center

FACT SHEET

WOW CONVENTION CENTER

General Information

WOW Convention Center is a convention center integrated with 4-star WOW Airport Hotel and 5-star WOW Istanbul Hotel where national and international congresses, company meetings, product introductions, dealers meetings, fairs and wedding etc. organizations can be held.

It is the biggest meeting facility of Istanbul with accommodation facility with 635 rooms.

There are Artemis, Zeus, Keops, Babil, İskenderiye and Rodos halls as well as Safir Hall, which is the biggest meeting hall of Istanbul with 3.108 m² area in Block A.

Location

WOW Convention Center is located at a walking distance from Istanbul Convention Center where important fair organizations take place. There is a metro station located in the garden of the facility connecting to the city center.

Distances

Istanbul International Airport	: 40 km / 50 minutes
City Center (Taksim)	: 20 km / 30 minutes
Bakırköy Sea Buses	: 10 km / 18 minutes
Ataköy Marina	: 9 km / 16 minutes
Sabiha Gökçen International Airport	: 60 km / 55 minutes

WOW CONVENTION CENTER A BLOCK

USAGE AREA OF HALLS

	Safir	Zeus	Artemis	Keops	Babil	İskenderiye	Rodos
Area	3.108 m ²	225 m ²	180 m ²	20 m ²	52 m ²	52 m ²	20 m ²

Hall Properties

Safir Hall

- 3.108 m², all without columns
- Divisible into 3 in 11 different ways
- Divisibility with separators soundproof up to 53 decibel
- 3 door entrances to Safir Hall
- 8,6 meter ceiling height
- 1.260 m² foyer area divisible into three
- Three different entrance doors to foyer
- 146 m² corresponding two symmetrical stage space
- Direct access from parking garage to the convention center foyer (by escalators)
- 2 separate loading doors for material and equipment transfer to Safir Hall from outside

Artemis and Zeus Halls

- Divisible into 3
- Divisibility with separators soundproof up to 53 decibel
- 4 meter ceiling height
- Artemis Hall foyer area 92 m²
- Zeus Hall foyer area 93 m²

Keops - Babil - İskenderiye - Rodos Halls

- 4 meetings halls of 20 m² – 52 m²
- Capacity options of 5 to 50 persons

Doors and Size

Safir Hall Material Entrance Doors

2 entrance doors for loading materials and equipment to Safir Hall at the size of 5,60 m width x 4,20 m height.

Safir Hall Foyer Entrance Photocell Doors

3 entrance doors to the main building at the size of 1,60 m x 2,35 m

Safir Hall Foyer Entrance Doors

3 entrance doors from the foyer to Safir Hall at the size of 1,78 m x 2,20 m

WOW Convention Center Block A Access

Entrance to all halls is provided by 3 photocell doors, and by stairs and escalators from the parking garage.

Access to Hotels

There is access to both hotels from Safir Hall.

HALL CAPACITY VALUES

WOW CONVENTION CENTER A BLOCK

Ground Floor

	Area	Hall (M ²)	Foyer (M ²)	Height (M ²)	Width (M)	Length (M)	Stage (Person)	Class (Person)	U Order (Person)	Banquet (Person)	Cocktail (Person)
Safir	A+B+C	3.108	1.260	8,6	42	74	4.000	1.980	-	2.000	3.000
	A	809	387	8,6	42	19,26	810	395	-	500	650
	A+	1.150	387	8,6	42	27,38	1.315	660	-	800	1.000
	A+B	1.958	858	8,6	42	46,61	2.380	1.090	-	1.400	1.600
	A+B+	2.298	858	8,6	42	54,71	2.920	1.385	-	1.420	2.000
	B	808	472	8,6	42	19,23	780	395	-	450	650
	B+	1.149	472	8,6	42	27,35	1.285	590	-	720	900
	+ B +	1.491	472	8,6	42	35,5	1.705	790	-	930	1.100
	B+C	1.916	866	8,6	42	45,61	2.380	1.090	-	1.400	1.600
	C	809	394	8,6	42	19,26	810	395	-	500	650
	C+	1.150	394	8,6	42	27,38	1.315	660	-	800	900
C+B+	2.299	866	8,6	42	54,73	2.920	1.385	-	1.420	2.000	
Zeus	A+B+C	225	93	4	10	22,5	235	155	65	140	150
	A	72	-	4	10	7,2	70	30	25	30	-
	B	81	-	4	10	8,1	85	45	30	40	-
	C	72	-	4	10	7,2	70	30	25	30	-
	AB	153	-	4	10	15,3	160	105	40	90	-
	BC	153	-	4	10	15,3	160	105	40	90	-
Artemis	A+B+C	180	92	4	9,6	18,7	195	120	55	110	100
	A	56	-	4	9,6	5,82	60	30	-	20	-
	B	56	-	4	9,6	5,82	60	30	-	20	-
	C	68	-	4	9,6	7,06	70	30	25	30	-
	AB	112	-	4	9,6	11,64	115	70	30	60	-
	BC	124	-	4	9,6	12,88	115	85	30	60	-
Mezzanine	Keops	20	-	2,4	3,6	5,5	15	-	10	-	-
	Babil	52	-	2,4	5,6	9,4	50	30	25	-	-
	İskenderiye	52	-	2,4	5,6	9,4	50	30	25	-	-
	Rodos	20	-	2,4	3,6	5,5	15	-	10	-	-

A BLOCK SAFİR HALL

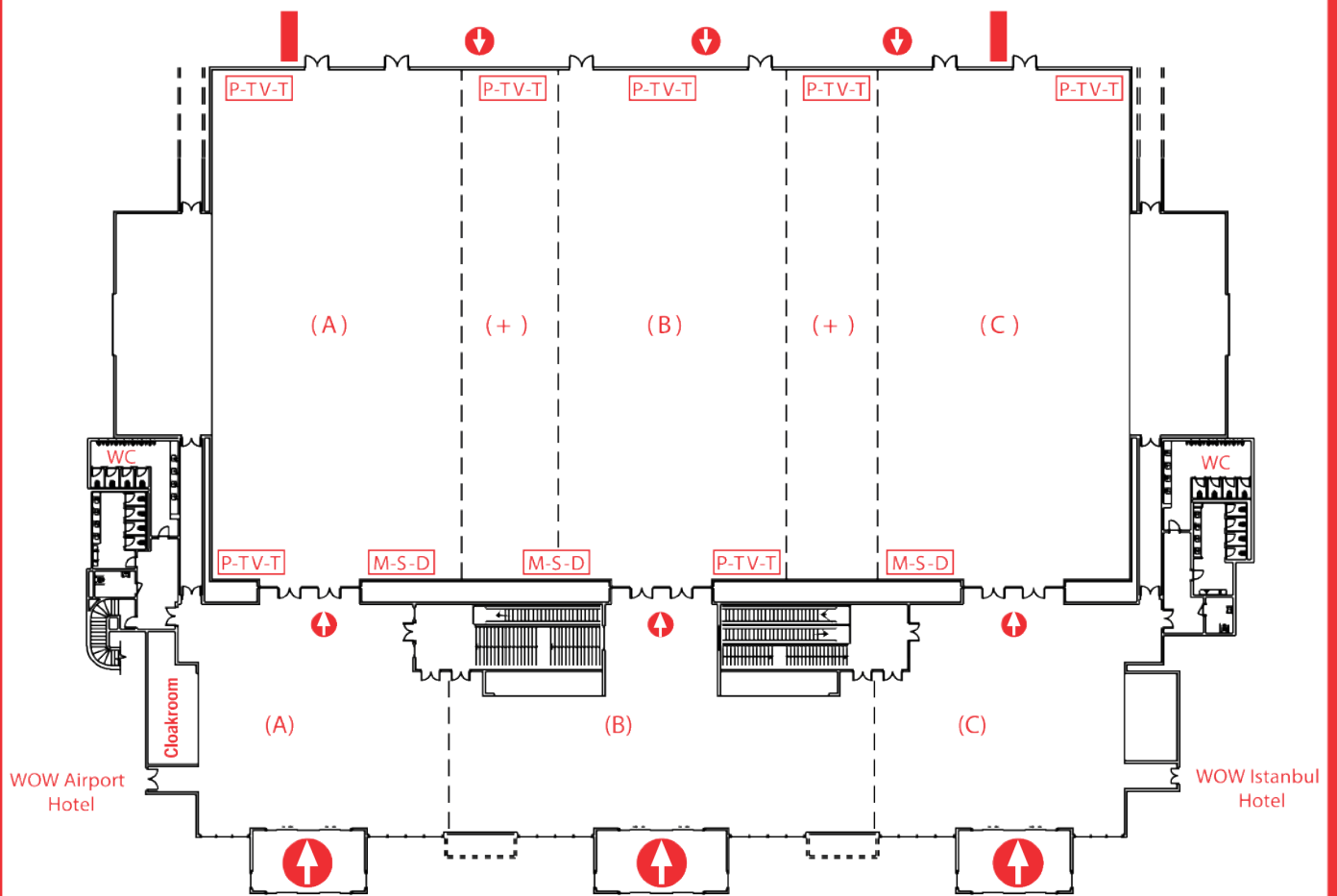

Width: 42 m
 Length: 74 m
 Height min: 7 m
 Height max: 8,6 m
 Area: 3,108 m²
 Foyer: 1,260 m²

P: Electricity
 I: Telephone Data Line
 M: Music
 S: Sound Control
 D: Dimmer Control

A BLOCK ZEUS HALL

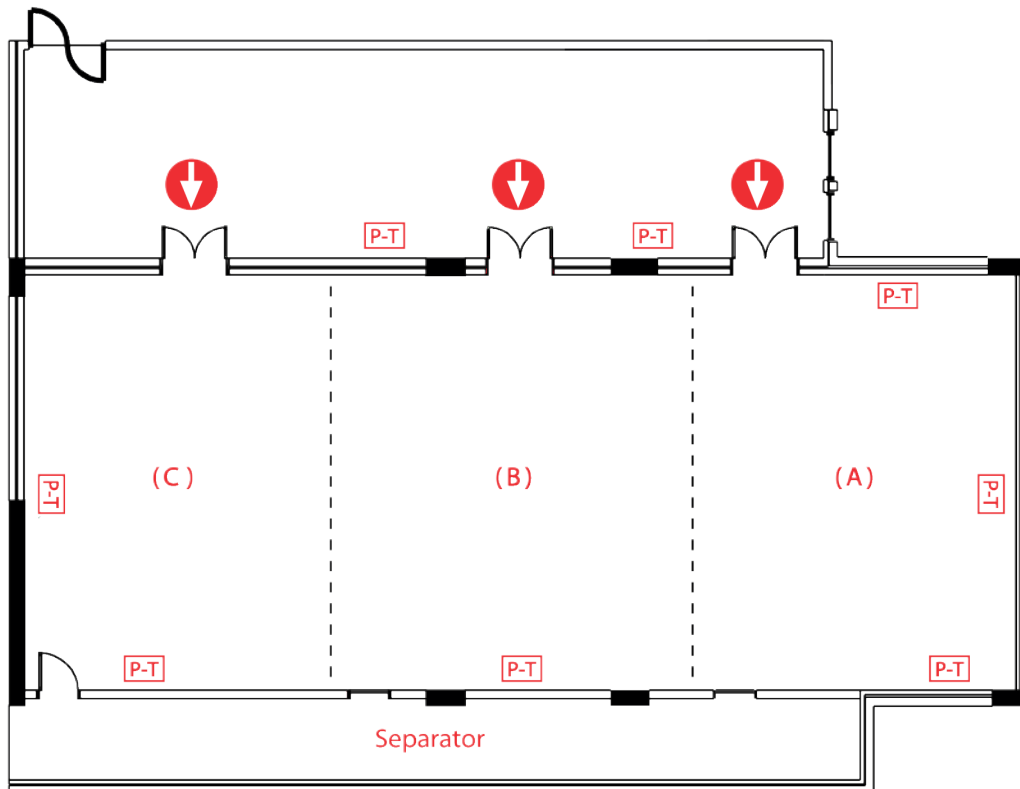

Width: 10 m
Length: 22,5 m
Height min: 4 m
Height max: 4 m
Area: 225 m²
Foyer: 93 m²

P: Electricity
I: Telephone Data Line

A BLOK ARTEMIS HALL

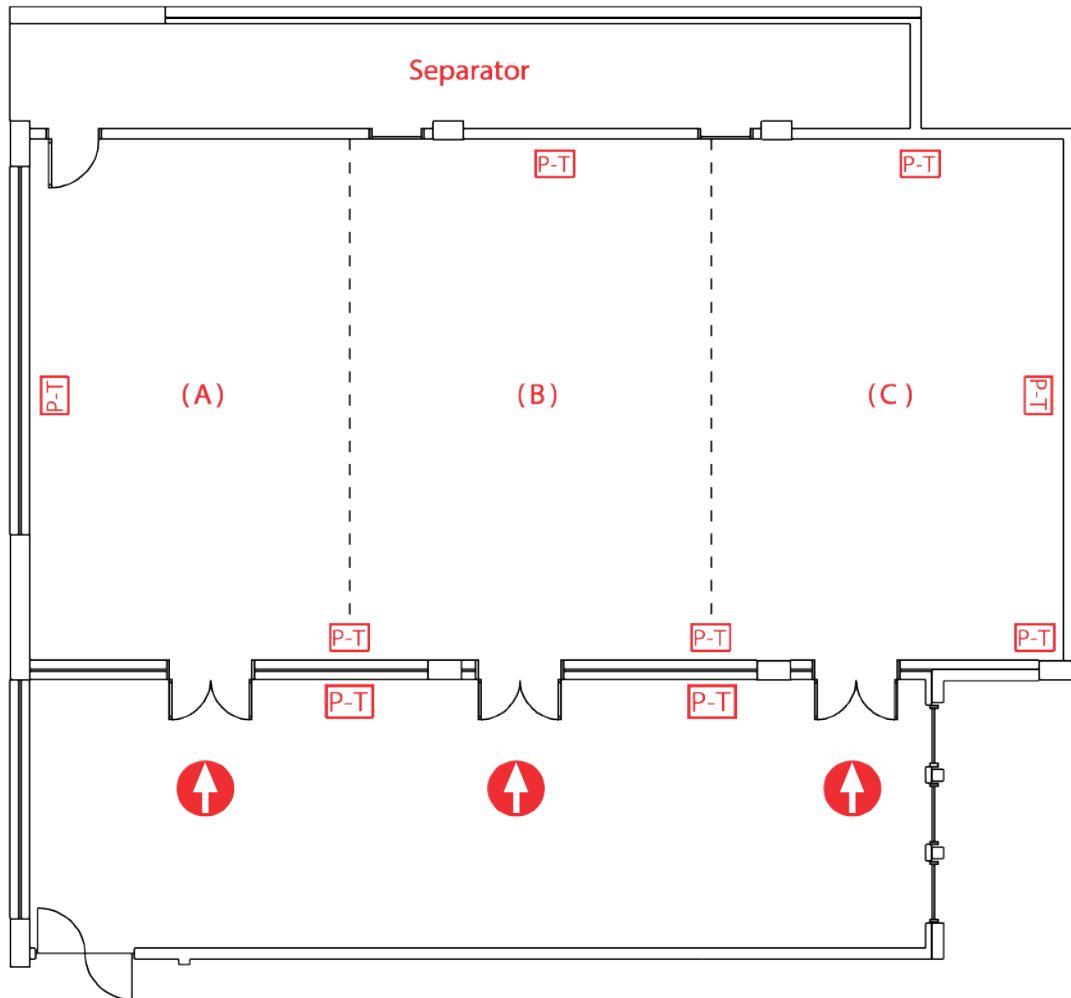

Width: 9,6 m
Length: 18,7 m
Height min: 4 m
Height max: 4 m
Area: 180 m²
Foyer: 92 m²

P: Electricity
I: Telephone Data Line

A BLOK MEZZANINE HALLS



KEOPS

Width: 3,6 m
Length: 5,5 m
Height min: 2,4 m
Height max: 2,4 m
Area: 20 m²

BABİL

Width: 5,6 m
Length: 9,4 m
Height min: 2,4 m
Height max: 2,4 m
Area: 52 m²

İSKENDERİYE

Width: 5,6 m
Length: 9,4 m
Height min: 2,4 m
Height max: 2,4 m
Area: 52 m²

RODOS

Width: 3,6 m
Length: 5,5 m
Height min: 2,4 m
Height max: 2,4 m
Area: 20 m²

P: Electricity

I: Telephone Data Line