



HONOR'S HAVEN

# *Meeting*



**HONOR'S HAVEN**

RETREAT & CONFERENCE

1195 ARROWHEAD ROAD, ELLENVILLE NY 12428

TOLL FREE : 877-969-4283 FAX : 845-210-1612

[WWW.HONORSHAVEN.COM](http://WWW.HONORSHAVEN.COM)





## *We Believe Breaks Between Sessions Should Take Your Breath Away!*

More than just great meeting space, Honor's Haven Resort & Spa offers meeting planners an ideal mix of business and pleasure. Centrally located just 90-minutes from Midtown Manhattan and Albany, Honor's Haven Resort & Spa can be found amid rolling hills and scenic woodlands, providing an inspiring setting; perfect for creativity and productive meetings/events of nearly any size. We invite you to explore the conference facilities provided by Honor's Haven Resort & Spa.

48,608 SQ FT	FUNCTION SPACE
232	ROOMS & SUITES
200	OUTDOOR BANQUET CAPACITY (Lakeside Tent)
2	REFRESHING POOLS (Indoor & Outdoor)
17,279 SQ FT	EXHIBIT CENTER (Indoor Tennis Center)
1	CHAMPIONSHIP 9 HOLE GOLF COURSE
19	MEETING ROOMS
1	SPA FOR TOTAL REJUVENATION





## *Versatile Event Space for Every Occasion*

Offering both adaptable and creative spaces, Honor's Haven Resort & Spa provides an energizing backdrop; ideal for your next meeting, conference or trade show.

## *Planning Made Easy*

Led by a team of industry professionals, Honor's Haven Resort & Spa provides the guest-focused and personal approach needed to produce a successful and memorable event.



## *Menus & Catering*

Under the leadership of our European trained Executive Chef, Honor's Haven Resort & Spa's culinary team caters to all tastes with an intercontinental menu; Featuring American, European, Kosher Style and Asian Fusion dishes.





# Pacific Ballroom

Dimension	60' x 86'
SQ FT	5160
Ceiling	11'6"
Theater	500
Classroom	200
Boardroom	N/A
Banquet	250
U-Shape	72
Circle	72

Air Conditioning Control	Yes
Wireless Internet	Yes
Wired Internet	Yes
Phone Line	N/A
Built-In Screen	Yes
Sound System	N/A

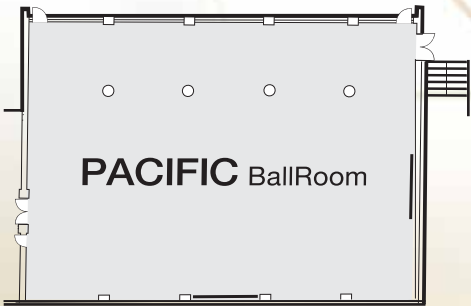





## Solarium Hall

Dimension	35' x 59'
SQ FT	2065
Ceiling	9'10"
Theater	120
Classroom	100
Boardroom	50
Banquet	100
U-Shape	50
Circle	75

Air Conditioning Control	Yes
Wireless Internet	Yes
Wired Internet	Yes
Phone Line	N/A
Built-In Screen	Yes
Sound System	N/A

Floor Plan

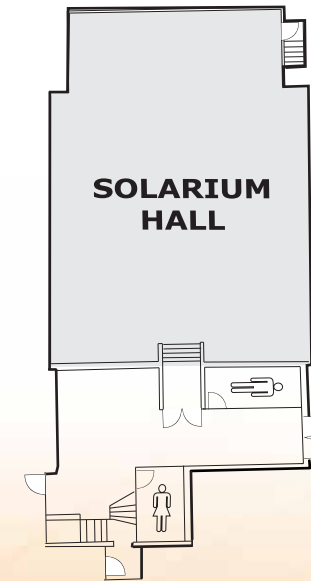



# Atlantic Hall

Dimension	56'6" x 87'6"
SQ FT	4943
Ceiling	9'6"
Theater	400
Classroom	170
Boardroom	N/A
Banquet	220
U-Shape	N/A
Circle	N/A

Air Conditioning Control	Yes
Wireless Internet	Yes
Wired Internet	Yes
Phone Line	N/A
Built-In Screen	Yes
Sound System	N/A

Floor Plan







	Dimension	SQ FT	Ceiling	Theater	Classroom	Boardroom	Banquet	U-Shape	Circle
Summit 1	35'10" x 25'6"	918	9'	56	24	32	60	24	24
Summit 2	27' x 43'	1161	9'	80	36	32	50	29	24
Summit 3	27'10" x 16'	448	9'	48	24	19	30	24	24
Summit 4	16'5" x 20'9"	342	9'	32	18	15	20	15	20
Summit 5	16'7" x 19'	313	8'4"	32	18	15	20	15	20

	Air Conditioning Control	Wireless Internet	Wired Internet	Phone Line	Built-In Screen	Sound System
Summit 1	Yes	Yes	Yes	N/A	N/A	N/A
Summit 2	Yes	Yes	Yes	N/A	Yes	N/A
Summit 3	Yes	Yes	Yes	N/A	Yes	N/A
Summit 4	Yes	Yes	Yes	N/A	Yes	N/A
Summit 5	Yes	Yes	Yes	N/A	N/A	N/A



## Summit Rooms

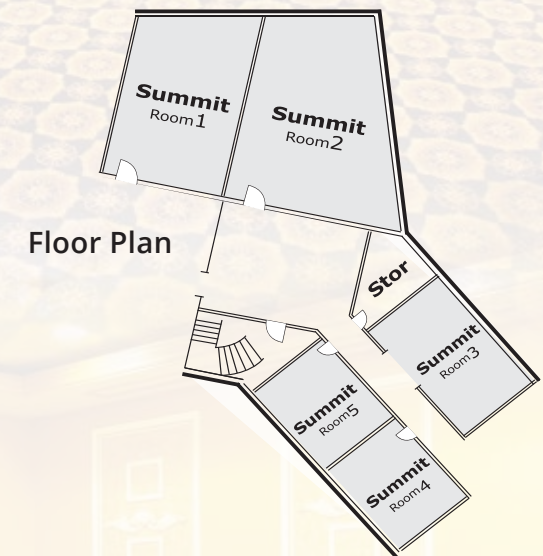



Conference Center



	Dimension	SQ FT	Ceiling	Theater	Classroom	Boardroom	Banquet	U-Shape	Circle
Conference 1	15'9" x 24'7"	385	9'6"	24	12	12	20	9	15
Conference 2	31'9" x 24'7"	767	9'6"	56	24	22	60	24	25
Conference 3	32' x 24'7"	784	9'6"	56	24	16	40	21	20
Conference 4	31' x 38'6"	1194	9'	100	70	40	70	35	30
Conference 5	28' x 31'8"	882	9'6"	72	32	22	60	26	25
Conference 6	28' x 31'8"	882	9'6"	72	32	22	60	26	25
Conference 7	28' x 15'8"	434	9'6"	24	12	12	20	9	15
Conference 1-2-3	79'6" x 24'7"	1947	9'6"	152	100	50	110	60	60

	Air Conditioning Control	Wireless Internet	Wired Internet	Phone line	Built-In screen	Sound system
Conference 1	Yes	Yes	Yes	N/A	N/A	N/A
Conference 2	Yes	Yes	Yes	N/A	N/A	N/A
Conference 3	Yes	Yes	Yes	Yes	Yes	N/A
Conference 4	Yes	Yes	Yes	N/A	Yes	N/A
Conference 5	Yes	Yes	Yes	N/A	Yes	N/A
Conference 6	Yes	Yes	Yes	N/A	Yes	N/A
Conference 7	Yes	Yes	Yes	N/A	Yes	N/A

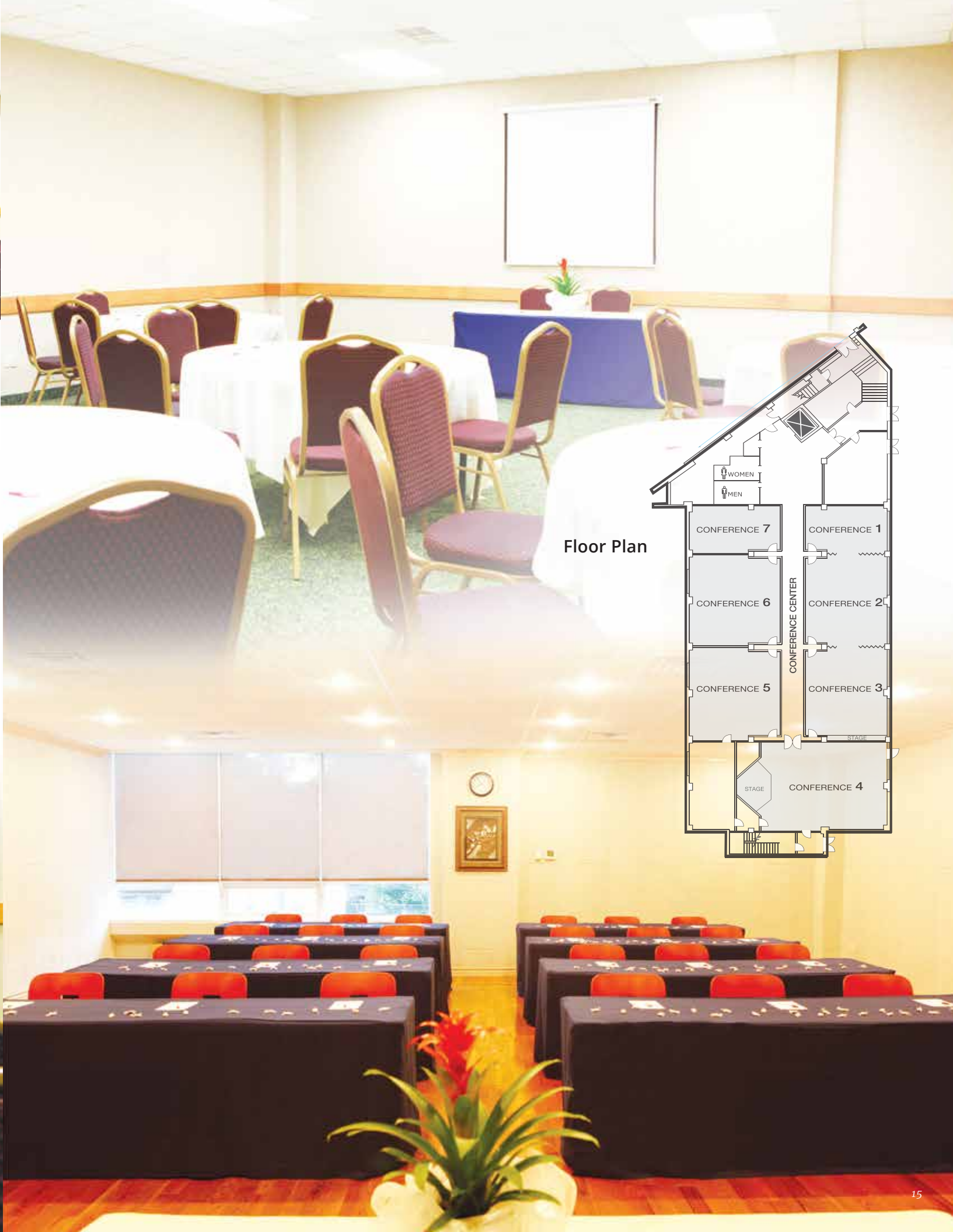

Floor Plan



Terrace View



Zephyr Lounge

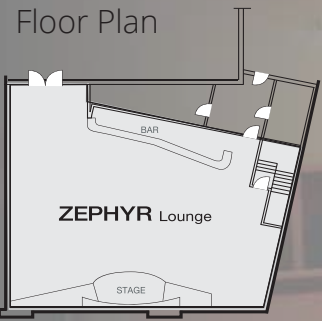

Lakeside Tent

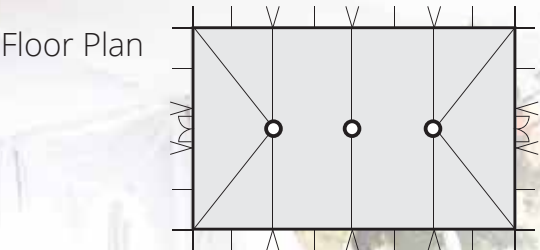

Floor Plan



Polaris Hall

	Dimension	SQ FT	Ceiling	Theater	Classroom	Boardroom	Banquet	U-Shape	Circle
Terrace View	38' x 47'	1786	9'	100	50	20	100	20	20
Polaris Hall	40'7" x 52'	2106	9' - 15'8"	124	100	60	N/A	50	50
Zephyr Lounge	38' x 54'	2052	8'	98	30	30	60	30	36
Exhibit Center (*)	116'9" x 148'	17279	13' - 30'	600	N/A	N/A	N/A	N/A	N/A
Meridian Hall	25' x 50'	1250	9'	120	48	48	N/A	40	44
Lakeside Tent	50' x 80'	4000	8' - 25'	400	N/A	N/A	200	70	70

	Air conditioning Control	Wireless internet	Wired internet	Phone line	Built-In Screen	Sound system
Terrace View	Yes	internet	Yes	N/A	Yes	N/A
Polaris Hall	Yes	Yes	Yes	N/A	Yes	Yes
Zephyr Lounge	Yes	Yes	N/A	N/A	Yes	N/A
Exhibit Center (*)	Yes	Yes	N/A	N/A	N/A	N/A
Meridian Hall	Yes	N/A	N/A	N/A	N/A	N/A
Lakeside Tent	N/A	Yes	N/A	N/A	N/A	N/A

(\*) Indoor Tennis Court

Exhibit Center





# Food & Beverage Options

Offering a wide array of catering options to suit your group’s needs, Honor’s Haven Resort & Spa will make your next event unforgettable!

*\*Please note that menu options are subject to change based upon availability*

## CLASSIC BUFFET DINING

Delight your senses with a mouth-watering selection of international dishes in the Hotel’s Main Dining Room, while soaking up picturesque views of our world Glass golf course and sparkling lake as well as the Shawangunk Mountains.

## PRIVATE DINING

A variety of private dining opportunities are also available at Honor’s Haven Resort & Spa.

Let our knowledgeable Food & Beverage staff assist you in creating customized menus suited to your event.

## ZEPHYR LOUNGE

Let the good times roll inside the Zephyr Lounge; featuring an array of beer, wine and specialty cocktails.

# Culinary Delights



## Breakfast

Wake up to our delicious breakfast buffet. Served in the Hotel’s Main Dining Room and bathed in the endless beauty of the surrounding countryside, our breakfast buffet offers a wide selection of entrees and friendly service.

## Lunch & Dinner

Indulge in a delightful array of authentic flavors during our lunch and dinner seatings. All entrees are paired perfectly with seasonal vegetables, a Chef-selected dessert; rewarding even the most discerning palate.

## Coffee Breaks

From freshly brewed to freshly baked, coffee breaks at Honor’s Haven Resort & Spa will help your team maintain their focus throughout the day.

## Receptions

Whether you’re looking for a casual welcome reception or a stylish pre-dinner affair, Honor’s Haven Resort & Spa can create a reception that is as unique as your event; offering savory fare and tiered beverage options (house, premium and top-shelf).

# Sample Menus

## Breakfast Buffet

Fluffy scrambled eggs, perfectly seasoned breakfast potatoes, crisp bacon or sausage, French toast or waffles with syrup, an assortment of fresh muffins, Danishes and seasonal fruit, a selection of individual yogurts, oatmeal, coffee and tea.

## Lunch Buffet

**SOUP**  
Hearty Tomato Basil Soup

**SALAD**  
Caesar Salad

**ENTREES**  
Beef Stir Fry with Fresh Vegetables, Grilled Chicken Breast with Homemade Mango Salsa, Asian Thai Chili Shrimp, Eggplant Rollatini, Seasonal Roasted Vegetables, Rice Pilaf

**DESSERT**  
Orange Cream Cake

Lunch buffets include fresh rolls with butter, coffee, tea and ice tea or lemonade.

## Dinner Buffet

**SOUP**  
French Onion Soup

**SALAD**  
Fresh Garden Salad with Homemade Dressings

**ENTREES**  
Grilled Sliced Steak with Homemade Mushroom Sauce, Chicken Parmesan, Stuffed Filet of Sole with Crabmeat and Shrimp Stuffing, Stuffed Shells, Roasted Red Bliss Potatoes, Sautéed Zucchini and Yellow Squash

**DESSERT**  
German Chocolate Cake

Dinner buffets include fresh rolls with butter, coffee, tea and ice tea or lemonade.

*\* We also offer the option of plated service, should your group prefer.(2 weeks notice required, additional fees may apply.)*

*Please inform our staff of any special dietary requests or allergies prior to your stay.*

## Coffee Breaks

**MORNING COFFEE BREAK**  
Sliced fresh seasonal fruit, assorted danish, coffee, tea and bottled water

**AFTERNOON COFFEE BREAK**  
Fresh baked cookies, assorted whole fruit, coffee, tea and bottled water

## Receptions & Beverages

**HORS D’ OEUVRES**  
Domestic Cheese and Cracker Display, Fresh Fruit Display, Franks en Croute, Tempura Shrimp, Chicken Lemongrass Potsticker Skewers

## Beverage Services

**OPEN BAR**  
Drinks are charged to the host at a specified per person price

**CONSUMPTION BAR**  
Drinks are charged to the host on a per drink basis

**CASH BAR**  
Guests are responsible for the payment of their own drinks

## Tiered Beverage Options

*\* House Brands may change based upon availability*

## HOUSE BRANDS

**PREMIUM**  
Smirnoff, Jim Beam, Beefeater, Johnnie Walker Red, Canadian Club, Reserva, 1800 Anejo, Seagram’s Seven Crown, Sparkling Wine, Casillero Del Diablo, Chille Cabernet Sauvignon, Chille Chardonnay, Liberty Greek Chardonnay, Assorted Soft Drinks and Mineral Water

**TOP SHELF**  
Bacardi Light, “Maker’s” Mark, Grey Goose, Hennessy, Patron Silver, Johnnie Walker Black, Booker’s Crown Royal, Sparkling Wine, California Cabernet Sauvignon, Black Stone, California Merlot, Frei Brothers Sonoma, California Chardonnay, New York Pinot Noir, Assorted Soft Drinks and Mineral Water



## Accommodations

Choose between any of our standard, executive, or suite accommodations; all designed to enhance your stay. Our spacious rooms combine understated elegance with modern amenities, many of which offer exceptional views of the glorious Shawangunk Mountains.

### Guest Rooms



Room Type   Standard  
Number       105  
Size           235~290 sqf  
Beds           One king bed or two double beds

The coziest of all of our lodging rooms, the Standard Room is both economical and perfectly situated within close proximity of the lobby and other main areas of the Hotel.



Room Type   Executive  
Number       107  
Size           360~420 sqf  
Beds           One king bed or two double beds

Enjoy beautiful views of the lake, golf course or picturesque mountainside. Most of our Executive Rooms offer connecting rooms for extended family, friends or co-workers.

### Suites



Room Type   Junior Suite  
Number       13  
Size           395~640sqf  
Beds           One king bed, two double beds or one king and one double bed

This large bedroom/parlor suite is situated within close proximity of the indoor & outdoor pool areas and spa, making this suite the perfect option for large families or long term stays.



Room Type   VIP Suite  
Number       3  
Size           820sqf  
Beds           One king bed

This generously sized two-room, two-bathroom suite offers a bedroom, large separate dressing area, sitting area with a sofa, and a refrigerator; making the VIP Suite perfect for families and individuals looking for upgraded accommodations.



Room Type   Presidential Suite  
Number       1  
Size           850 sqf  
Beds           One king bed and two rooms

This two-story, two bathroom suite with Jacuzzi and separate dressing area provides the highest level of comfort with separate living room and refrigerator stocked with beverages and wine.

## Group Offerings

Look to Honor’s Haven Resort & Spa for countless group travel opportunities!

### Group Package

#### Reunion Package

Heart-to-hearts on roller coasters & catching up with cousins is tough while battling endless lines. Trade in the traditional tourist attractions and focus on what is really important; your family.



#### Religious Retreats Package

Accommodating youth, family, and couple retreats since 2007, Honor’s Haven Resort & Spa provides an engaging and educational environment which is ideal for unlocking the spiritual potential of your members. Leave your congregation more inspired, more connected, and ready to explore their faith!



#### Wellness Package

We warmly welcome your group to utilize our dynamic function spaces for your next retreat, workshop, conference or outing. We also offer customizable wellness retreat services to supplement and enhance your stay.



### Meeting Packages

Meet with distinction. Honor’s Haven Resort & Spa offers a newly renovated facility with metropolitan touches, natural elements and corporate appeal.

#### Standard Meeting Package Includes:

Standard Accommodations, 3-Buffer Meals Daily, Afternoon Refreshment Break Each Day, Meeting Space, Use of Resort Facilities and Complimentary Wireless Internet Access.



#### Complete Meeting Package Includes:

All of the Same Inclusions as the Standard Meeting Package Plus: Morning Refreshment Break Each Day, Cocktail Reception One Evening Prior to Dinner and Upgrades to Executive Accommodations. Upgrades Based Upon Availability.



#### Grand Meeting Package Includes:

All of the Same Inclusions as the Standard Meeting Package Plus: Welcome Reception at Check-In, Morning Refreshment Break Each Day, Cocktail Reception One Evening Prior to Dinner and Upgrades to Executive Accommodations. Upgrades Based Upon Availability.





# Nearby Attractions

Choose your adventure! Whether your group is looking for a night at the theatre, a tour of the region’s magnificent wineries or a day hitting the slopes, the shops and the slots, Honor’s Haven Resort & Spa is at the heart of an area rich in local history, outdoor adventure, culture and festivals that are unique to the region.

SAM’S POINT PRESERVE



MINNEWASKA STATE PARK

BETHEL WOODS



SHAWANGUNK WINE TRAIL

HOLIDAY MOUNTAIN



HORSEBACK RIDING

WOODBURY COMMONS



MONTICELLO CASINO/RACEWAY

