

JASMINE ROOM
B Level

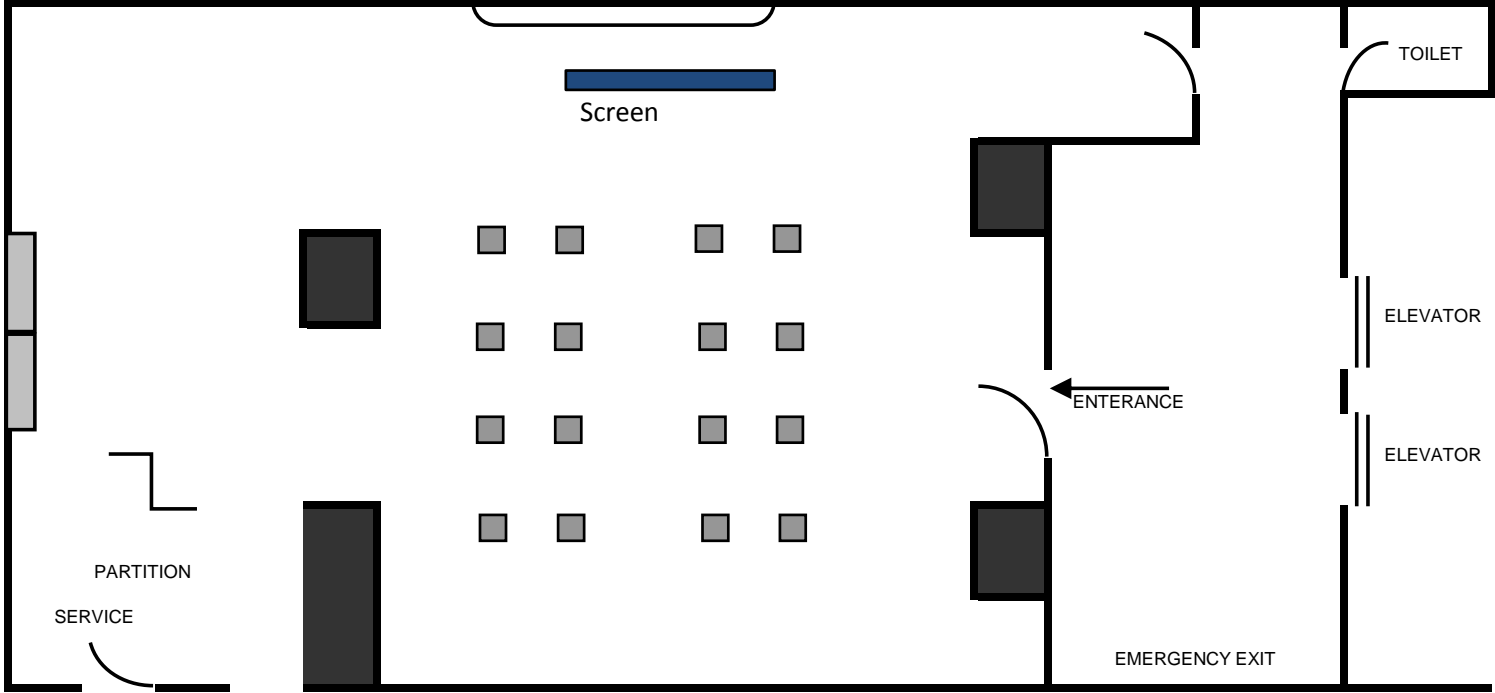

16 PAX - THEATER SET UP

Room size : 8 x 10 meter

Ceiling size : 2.1 meter

**RAFFLESIA ROOM
Lower Lobby Level**

Upper Level

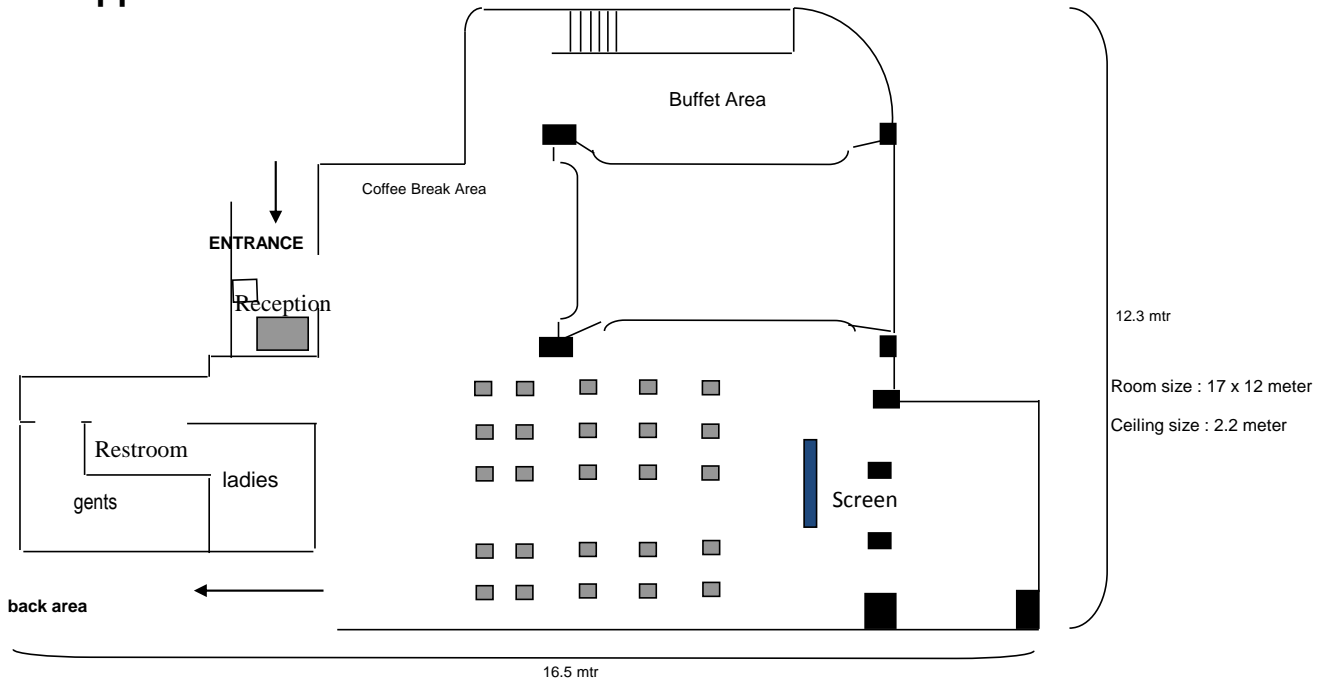

Lower level

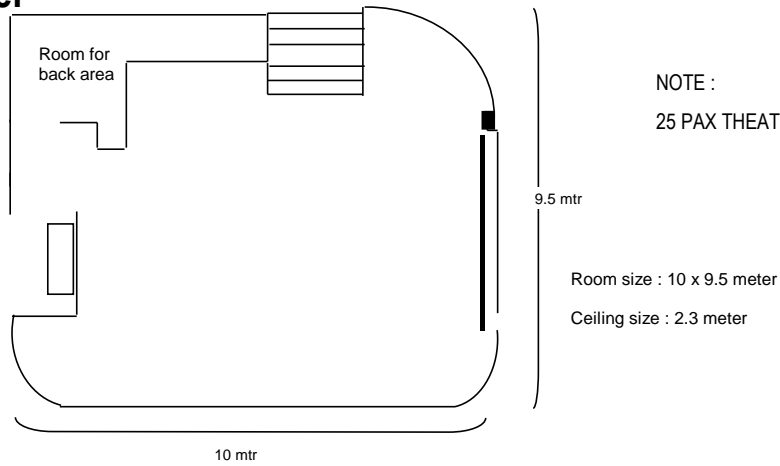

NOTE :
25 PAX THEATRE SET UP ON UPPER LEVEL

GARDENIA ROOM
Lobby Level

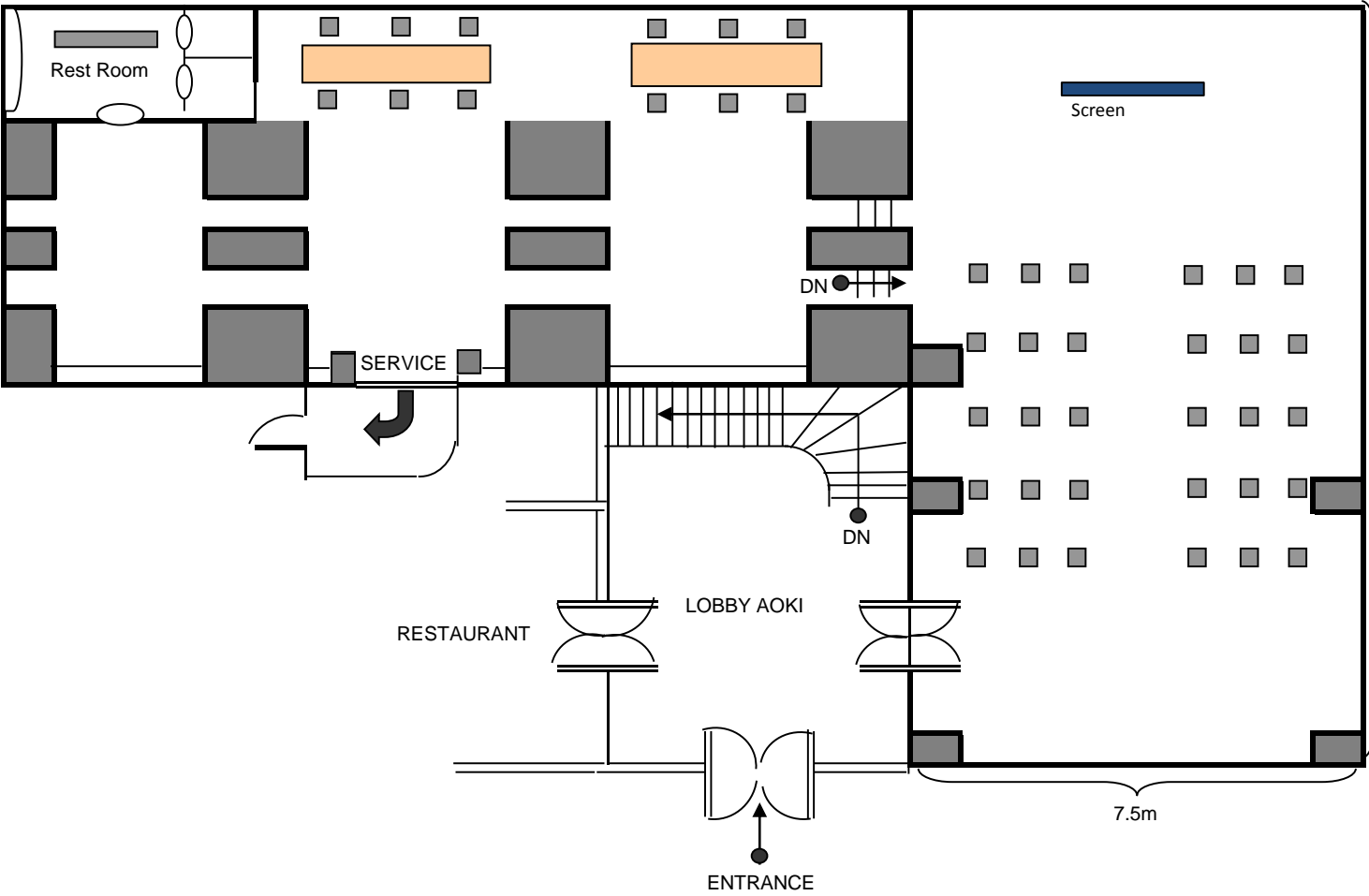

18m

Room size : 18 x 7.5 meter
Ceiling size : 2.9 meter

7.5m

LOWER LEVEL : 30 PAX - THEATER SET UP

**MAGNOLIA BALLROOM
2nd Floor**

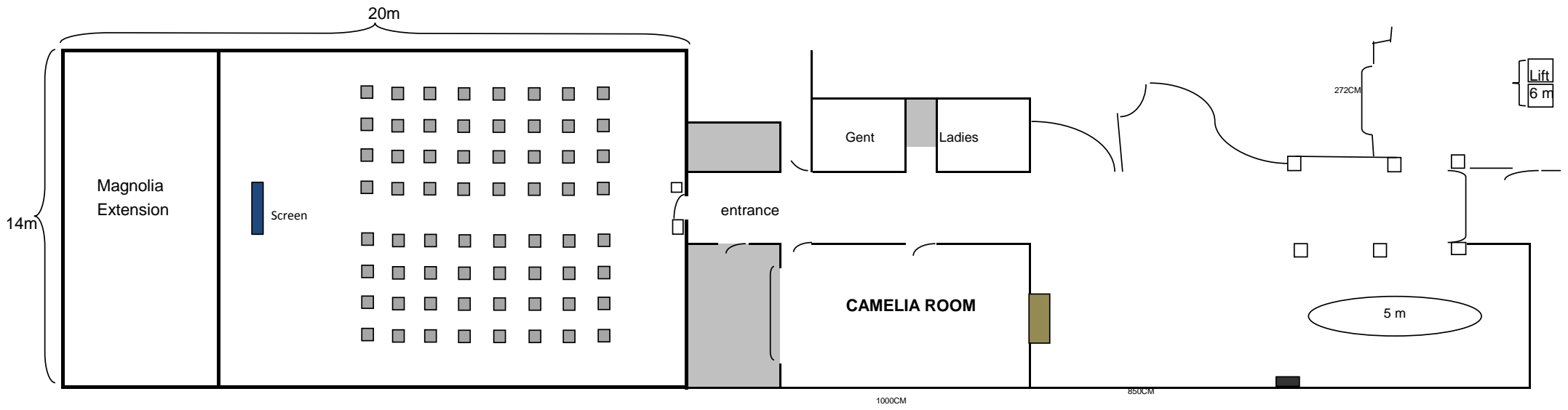

MAGNOLIA BALLROOM
64 PAX in THEATER SET UP

Room size : 14 x 20 meter
Ceiling size : 3.1 meter

1000CM

850CM

272CM

5 m

Lift
6 m

CAMELIA ROOM
2nd Floor

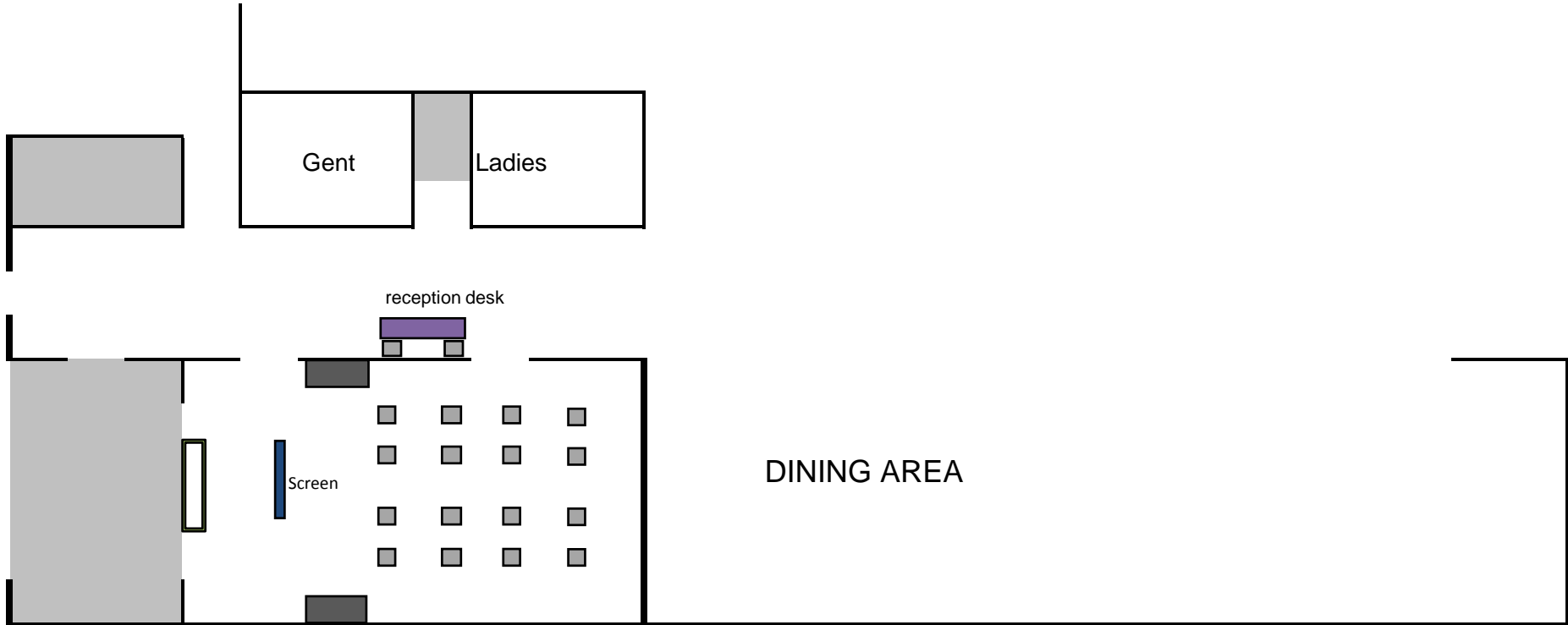

Gent

Ladies

reception desk

Screen

DINING AREA

1000CM

16 PAX - THEATER SET UP

Room size : 10 x 6 meter

Ceiling size : 3.1 meter

CASABLANCA ROOM 6th Level

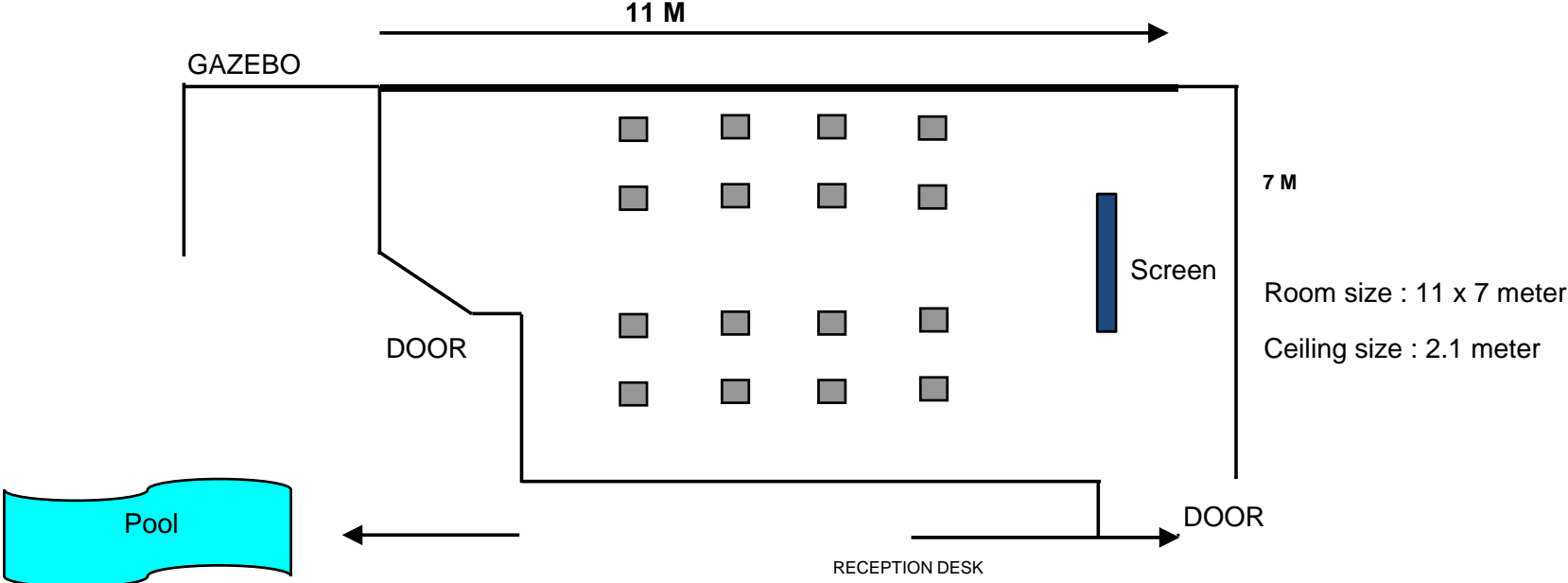

16 PAX - THEATER SET UP