

# INBALANCE MEETINGS

AT NOVOTEL

SYDNEY DARLING SQUARE

NOVOTEL









# TABLE OF CONTENTS\_

\_About

\_Location

\_Pumphouse Sydney

\_AllConnect

\_Inbalance Meetings

\_Our Spaces

\_Floor Plans

\_InBalance Delegate Packages

\_Catering

\_Audio Visual







# ABOUT NOVOTEL SYDNEY DARLING SQUARE\_



Novotel Sydney Darling Square is the perfect home away from home, during your meeting, conference or event. The hotel offers 230 contemporary accommodation rooms with views overlooking the Darling Square precinct and The Chinese Garden of Friendship.

Hotel rooms feature large Smart TVs with access to streaming services. Enjoy using your electronic devices with complimentary high-speed Wi-Fi and USB charging points conveniently located throughout the room.

Relax in our bathrooms with well-lit vanity mirrors and large showers, featuring dual heads that includes a rainfall shower head. Guests can also relish in Novotel's fair trade bathroom amenities during stays. Stay in and enjoy in-room dining and mini bar on demand.





Novotel Sydney Darling Square outlook from the Chinese Gardens of Friendship



## LOCATION\_

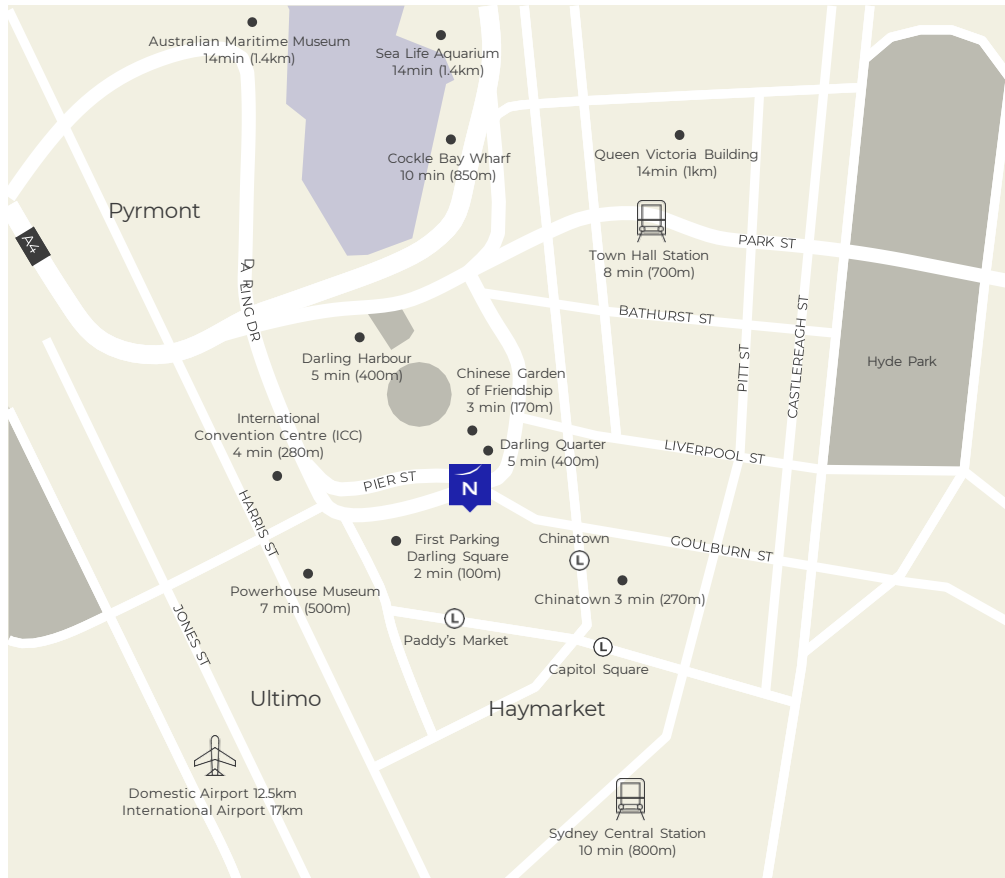

Novotel Sydney Darling Square is located in the heart of Darling Square, one of Sydney's most vibrant precincts. Quickly becoming the city's premier destination for food, retail and culture.

The hotel is positioned in the CBD and provides easy access to the city's key landmarks, such as; Sydney Central Station; International Convention Centre; Darling Harbour; Chinese Garden of Friendship and China Town. All accessible within a short walk.

Travelling to and from the hotel is convenient, with the property being well located amongst Sydney's main arterial motorways. Sydney Harbour Bridge, ANZAC Bridge and the Eastern Distributer. With Sydney's airports accessible within a 20-25 minute drive.





Pumpphouse Sydney Main Bar Area





#### **A MODERN MIX OF INDUSTRIAL + CRAFT**

Pumphouse Sydney Bar & Restaurant serves and produces a range of different craft and premium brews, and sells bespoke wines to add a little theatre to the Pumphouse Sydney experience.

The sophisticated new space boasts an industrial design with high end finishes, from the statement lamp shades over the bar which feature the work of Australian artist Lance Corlett, to the stunning timber bar and intimate wine room, available for private dining and tastings.

The wine room features a broad selection of wines from various international and local winemakers, with QR codes visible to be scanned to review tasting notes and select your perfect drop.

Pumphouse Sydney is proudly and authentically Sydney. With a menu inspired by seasonal produce, there is always something new and fresh to satisfy all. Simple, rustic + flavoursome is our notion.

Escape to The Terrace that overlooks Darling Square. A place for cocktails, brunches, socialising in the sunshine and taking in the views of our city of Sydney.







# ALL CONNECT\_

**Introducing ALL CONNECT, Accor's one-stop shop hybrid meetings dedicated solution. Enabling meeting planners to seamlessly organise both live and virtual gatherings worldwide in a safe and efficient way.**

## **Best in class technology partners**

Our ALL CONNECT services in partnership with Microsoft Teams include hybrid meetings equipment with leading audio and visual solutions that seamlessly brings together physical and virtual audiences into one live experience. So everyone feels included wherever they are.

## **Safe environment**

Enjoy the comfort of a meeting room and all the benefits of hotel hospitality services. The highest sanitary and safety measures are assured thanks to our expert-vetted ALLSAFE program with bespoke meetings protocols. Engage with your audience and ensure a complete peace of mind for your live attendees.

## **Successful meetings**

Whatever your budget, our dedicated Meetings and Events experts will support meeting planners in finding the best ways to organise successful events. From workshops and training days to multi-day conferences, our teams are on hand to provide the perfect hybrid meeting experience, online and onsite.

## **Flexible sales conditions and rewards**

We have launched worldwide flexible and favourable terms and conditions to meet professionals' needs. Plus, members of ALL – Accor Live Limitless can earn Reward points for every meeting booked through the ALL Meeting Planner offer. Be in the room. Get rewarded.







# INBALANCE MEETINGS

## AT NOVOTEL

### \_OUR INTENT

A place for people to meet, focus their energy and create moments of impact to achieve great meeting outcomes.

### \_MISSION STATEMENT

For every guest to leave a Novotel feeling calm, grounded, clear-headed and motivated. In our words they are balanced.







# OUR SPACES\_

## WHERE SMALL GROUPS COME UP WITH BIG IDEAS

Novotel Sydney Darling Square is the ideal venue for small to medium sized functions, meetings and conferences for up to 120 guests. With six dedicated conference and meeting rooms, each room offers an abundance of natural light.

Whether you're looking to organise a small board meeting, a mid-size corporate event, or even a themed cocktail event for up to 400 people at Pumphouse Sydney, speak with our dedicated meetings team, who will be able to assist you in finding out the ideal solution.

### **Darling Harbour Room**

- 168 square metres
- Located on level 1 near breakout rooms
- Floor to ceiling windows
- Dual data projectors
- Electric black out blinds
- Maximum 120 guests

### **Little Pier Room**

- 92 square metres
- Located on ground floor with private pre-function space
- Floor to ceiling windows
- Data projector and screen
- Electric black out blinds
- Maximum 70 guests

### **Tumbalong Room**

- 68 square metres
- Located on level 1 near breakout rooms
- Floor to ceiling windows
- Large touch screen TV
- ALL Connect Microsoft Teams equipment
- Electric black out blinds
- Maximum 50 guests

### **Pymont Bay Room**

- 46 square metres
- Deluxe boardroom
- Located on level 1, heritage section of property
- Unique arch windows providing natural light
- Large touch screen TV
- Electric black out blinds
- Maximum 32 guests

### **Blackwattle Bay Room**

- 46 square metres
- Located on level 1 near breakout rooms
- Natural light
- Unique space for meetings
- Dedicated lounge area
- Large touch screen TV
- Maximum 30 guests

### **Cockle Bay Room**

- 33 square metres
- Located on level 1 near breakout rooms
- Floor to ceiling windows
- Large touch screen TV
- ALL Connect Microsoft Teams equipment
- Electric black out blinds
- Maximum 20 guests

#### **Interested in a virtual tour?**

Hit the button below to explore our spaces

Powered by:  
[Yellow Door Productions](#)





Little Pier Room



Pyrmont Bay Room



Blackwattle Bay Room



Tumbalong Room



Cockle Bay Room



# FLOOR PLANS\_

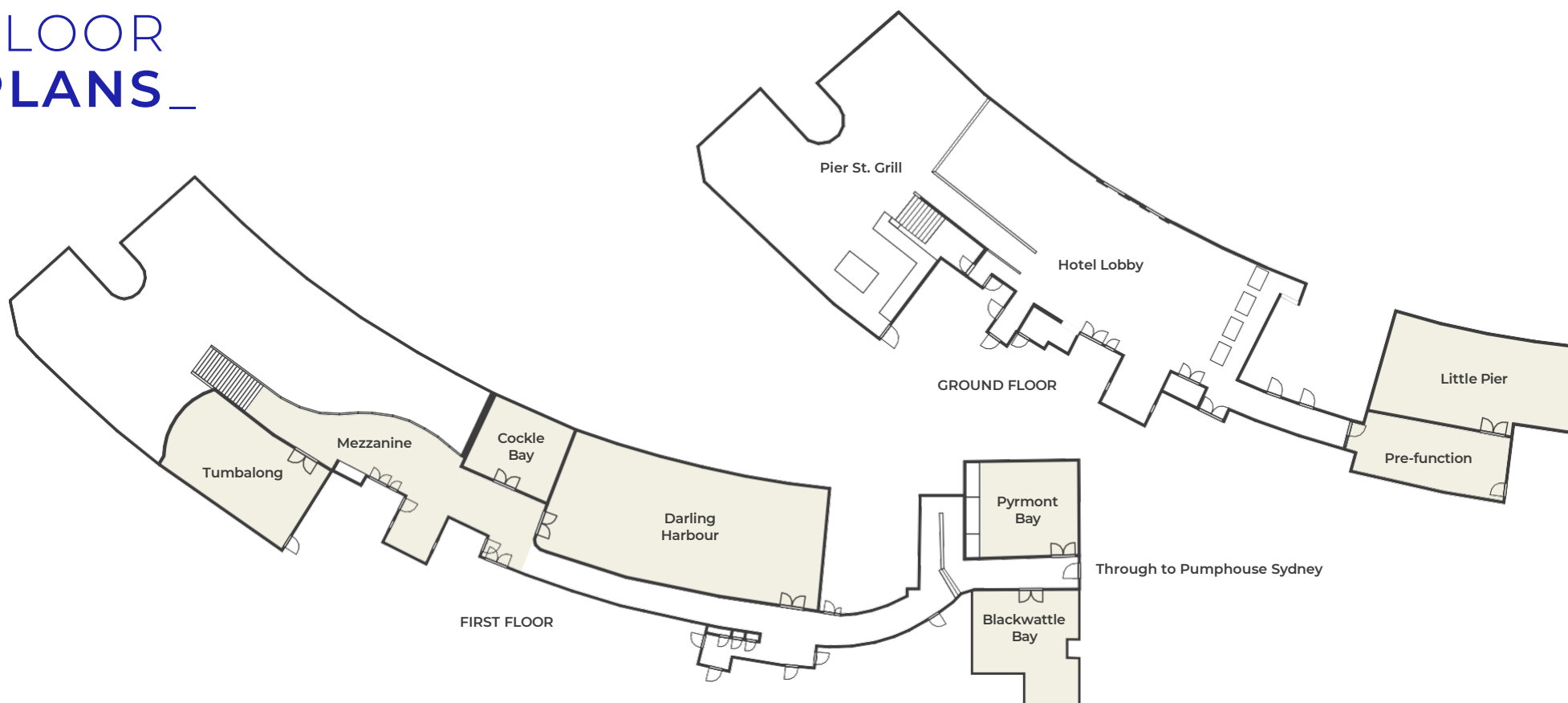

	Sqm	Height	Banquet	Cabaret	Theatre	Classroom	Boardroom	U-Shape	Cocktail
Darling Harbour	168	2.4	100	80	120	72	24	30	120
Little Pier	92	2.4	50	40	70	36	26	27	60
Tumbalong	68	2.4	40	32	49	30	20	21	40
Pyrmont Bay	46	2.4	30	24	32	18	14	15	25
Blackwattle Bay	46	2.4	30	21	30	12	10	12	25
Cockle Bay	33	2.4	20	16	24	15	14	15	15



# AUDIO VISUAL\_



Equipment requirements over and above projection, flipcharts or whiteboards can be hired from our preferred partner Audio Visual Events. AVE has built their reputation by delivering Sydney's best AV solutions over the past 20 years. Their team provide technical support, creativity, and event expertise, ensuring the journey from event brief to delivery is seamless.

Please advise your sales representative of your full requirements to organise a quote, or email AVE at [nsds@audiovisualevents.com.au](mailto:nsds@audiovisualevents.com.au)



# NOVOTEL

SYDNEY DARLING SQUARE

17 LITTLE PIER STREET DARLING HARBOUR NSW 2000 AUSTRALIA | E: [17021-SD@accor.com](mailto:17021-SD@accor.com) | T: +61 2 8217 4022

FOLLOW OUR SOCIALS | Facebook: [novotelsydneydarling-square](https://www.facebook.com/novotelsydneydarling-square) | Instagram: [novoteldarling-square](https://www.instagram.com/novoteldarling-square)