

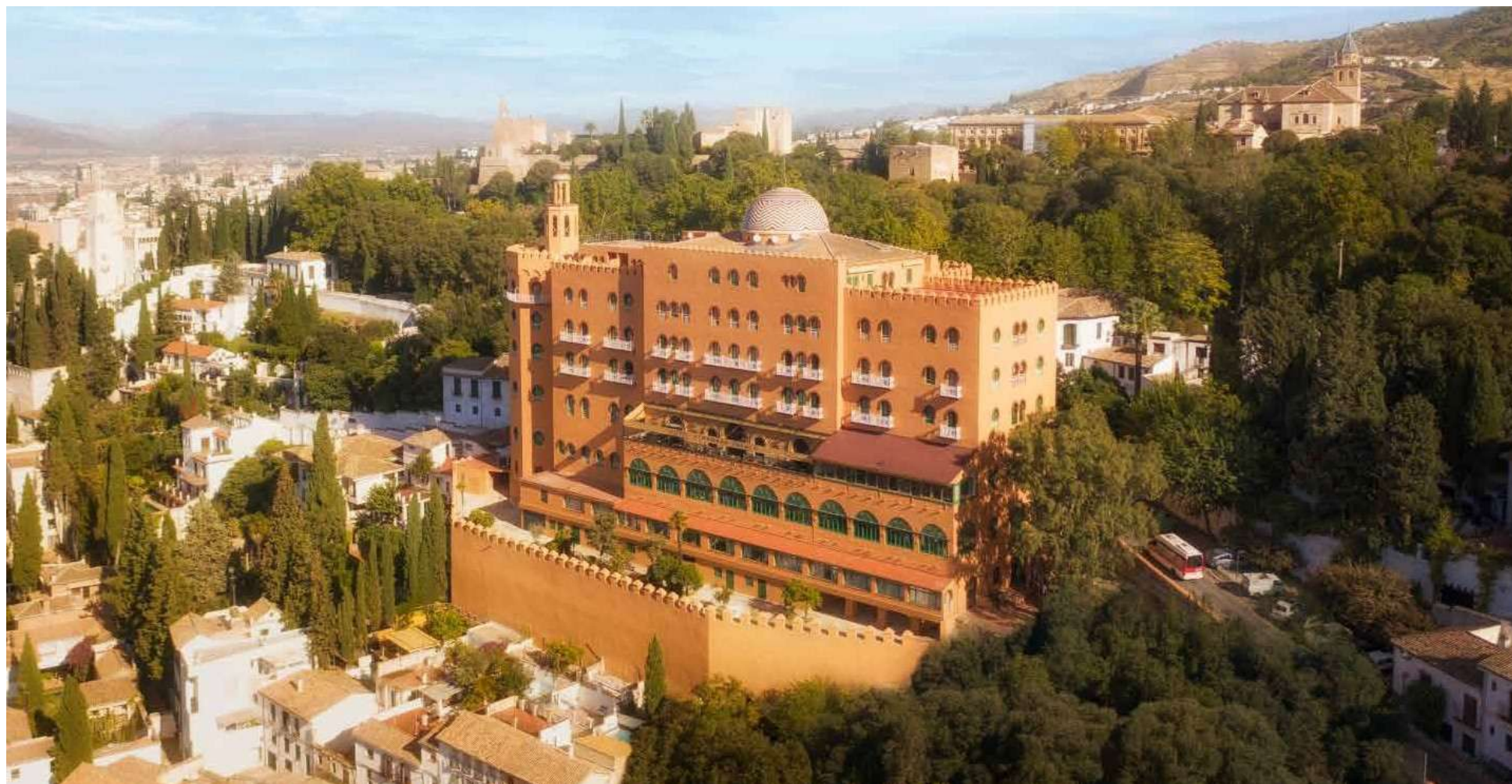

HOTEL  
ALHAMBRA PALACE  
— DESDE 1910 —  
★★★★★



Tlf.: +34 **958 22 14 68**  
Plaza Arquitecto García de Paredes, 1  
18009 GRANADA (SPAIN)

[reservas@hotelalhambrapalace.com](mailto:reservas@hotelalhambrapalace.com)  
[www.hotelalhambrapalace.com](http://www.hotelalhambrapalace.com)



Be part of the legend of the hotel with the longest history in Spain.

Overlooking the city of Granada, 5 minutes walk to the royal palaces of the Alhambra.

Since 1910 the hotel has been a symbol of luxury, pleasure, elegance and hospitality at the highest level. Inspired by the beautiful Nasrid palace, it is an ode to attention to detail. More than a century of history to live a unique experience in an emblem of international tourism.

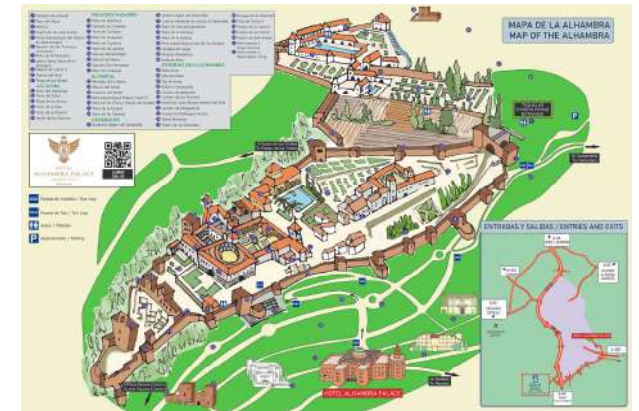

Updated in 2026, enjoy the luxury of resting in a palace surrounded by the Alhambra Forest, only 10 minutes walk to the city center.

Discover our prestigious cuisine Andalusian roots, season and proximity. Our products are grown in our own organic urban garden, which we accompany with a surprising wine list. With the elegance of an arab palace and admiring the incredible sunsets of Granada.

We offer gastronomy and relaxation in our terraces and panoramic rooms, as well as the celebration of events and incentives in our spectacular panoramic rooms, keeping the original decoration, but offering the latest technological advances of the XXI Century.



# Restaurant & Terrace

## Restaurant “Príncipe”

Fully renovated in 2024.

Andalusian cuisine considers food as a source of life, nutrition and healing. It unites flavours and sensations, making eating well a pleasure for life and the senses. At the Hotel Alhambra Palace we recover recipes, which are a gift from the past, updated and renewed for our guests.

To guarantee seasonal and local products, the Alhambra Palace Hotel has developed and implemented an urban organic garden.



## Panoramic Terrace

Fully renovated in 2024.

Let yourself be captivated by the magic of our panoramic terrace.

You will enjoy sunsets, starry nights, Andalusian and Mediterranean cuisine based on local produce and our own ecological gardens.

You will be able to toast these memorable moments with carefully selected cocktails.

## 4 Two bedroom Suites

All our two bedroom suites have two spacious, independent, and bright bedrooms; two bathrooms; and a shared living space.

Some are accentuated with a fantastic, crenelated balcony overlooking the city of Granada and the Alhambra Gardens—such glamorous surroundings make for a breakfast in true Nazrid style. Size; Suites from 67 to 80 m<sup>2</sup>. Terraces from 18 to 95 m<sup>2</sup>.



### **Facilities in rooms:**

- Safety Box
- Wardrobe Closet
- Desk
- Mini fridge
- Internet
- Hairdryer
- Air conditioning
- Nespresso and kettle
- Coffee and tea
- Mineral water
- Wooden and marble floors
- Living room
- Freestanding bathtub
- Rain shower cabin
- Hairdryer
- Slippers
- Bathrobes
- Bathroom amenities

# 11 One Bedroom Suites

The original decorations— including ornate plasterwork ceilings, copper accents and prestigious hardwoods—have been carefully preserved so that you can genuinely experience what it was like to live in the Alhambra. Views to Granada, its fertile valley, and Sierra Nevada. Size from 43 to 59 m2. King size or twin beds. Updated in 2025.



## Facilities in rooms:

- Safety Box
- Wardrobe Closet
- Desk
- Mini fridge
- Internet
- Air conditioning
- Nespresso and kettle
- Coffee and tea
- Mineral water
- Marble floors
- Living room
- Rain shower cabin
- Hairdryer
- Slippers
- Bathrobes
- Bathroom amenities

## 6 Deluxe

The warm, Granada sunshine streams through Nasrid latticework, brightening a room harmoniously decorated with wood, marble, and state-of-the-art designs.. Size from 33 to 41 m2.

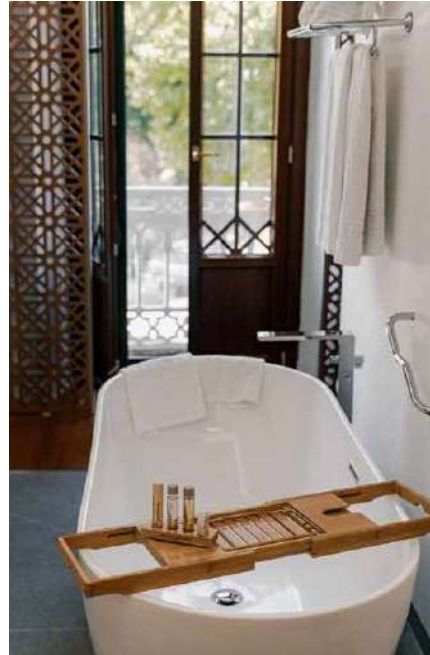

### **Facilities in rooms:**

- Safety Box
- Wardrobe Closet
- Desk
- Mini fridge
- Internet
- Air conditioning
- Nespresso and kettle
- Coffee and tea
- Mineral water
- Wooden and marble floors
- Freestanding bathtub
- Rain shower cabin
- Hairdryer
- Slippers
- Bathrobes
- Bathroom amenities

## 45 Classic City Views

These rooms are charming and luminescent, with hand-selected decorations in soft tones and spectacular bathrooms with intricate tiles like those of the Nasrid palaces. Enjoy our unforgettable views of the city of Granada, its fertile valley and Sierra Nevada. Size from 23 to 29 m2. Updated in 2025.



### **Facilities in rooms:**

- Safety Box
- Wardrobe Closet
- Desk
- Mini fridge
- Internet
- Air conditioning
- Nespresso and kettle
- Coffee and tea
- Mineral water
- Carpeted or wooden and marble floors
- Slippers
- Bathrobes
- Hairdryer
- Bathtub or walking shower
- Bathroom amenities



Quiet rooms with views of the centennial forest of the Alhambra. Traditional decor and bathrooms with unique Moorish tiles and all the amenities. Size from 23 to 29 m2.

## 34 Classic Exterior Views



### Facilities in rooms:







- Safety Box
- Wardrobe Closet
- Desk
- Mini fridge
- Internet
- Air conditioning
- Nespresso and kettle
- Coffee and tea
- Mineral water
- Carpeted or wooden and marble floors
- Slippers
- Bathrobes
- Hairdryer
- Bathroom amenities

## Meetings & Events

Unique & original meeting rooms from 1910 that are part of the history of Granada and Spain, as they have hosted the main events of our city in the last 114 years.

Neo-Nasri decoration with muqarnas, plasterwork, coffered ceilings and tiles, perfectly preserved thanks to the protection as a cultural space. Natural light in all of them except in the Theater Hall, and all the technical needs required for today's events.

MEETING	HEIGHT (M.)	AREA (M <sup>2</sup> )
Árabe	5.00	89
Reyes Católicos	5.00	126
Terraza Mirador	4.24	127
Teatro	6.00	90
Sierra Nevada	3.95	45
Restaurante	5.95	215
Terraza Príncipe	2.50	63

MEETING	CAPACITY					
						
Árabe	120	40	80	92	90	42
Reyes Católicos	180	60	100	150	110	60
Terraza Mirador	-	-	-	110	120	-
Teatro	130	35	80	84	90	-
Sierra Nevada	25	21	20	-	-	-
Restaurante	-	-	-	170	220	-
Terraza Príncipe	-	-	-	56	60	30

### Facilities in meeting rooms:

Air conditioning  
Lectern  
Adjustable lights  
Natural light  
PA system  
Internet  
Screen  
Blackboard  
Flipchart  
Computer  
Slide projector  
Overhead projector

### Facilities on request:

Entertainment and shows  
Hostesses  
Translation  
Secretaries  
Security  
Printing  
Messaging  
Photocopier  
Scanner  
Audiovisuals  
Computers  
VideoTv  
Video projector

# Salón Reyes Católicos

## MEETING ROOMS HEIGHT (M.) AREA (M<sup>2</sup>)

Reyes Católicos 5.00 126

## MEETING ROOMS CAPACITY

Reyes Católicos	180	60	100	150	110	60

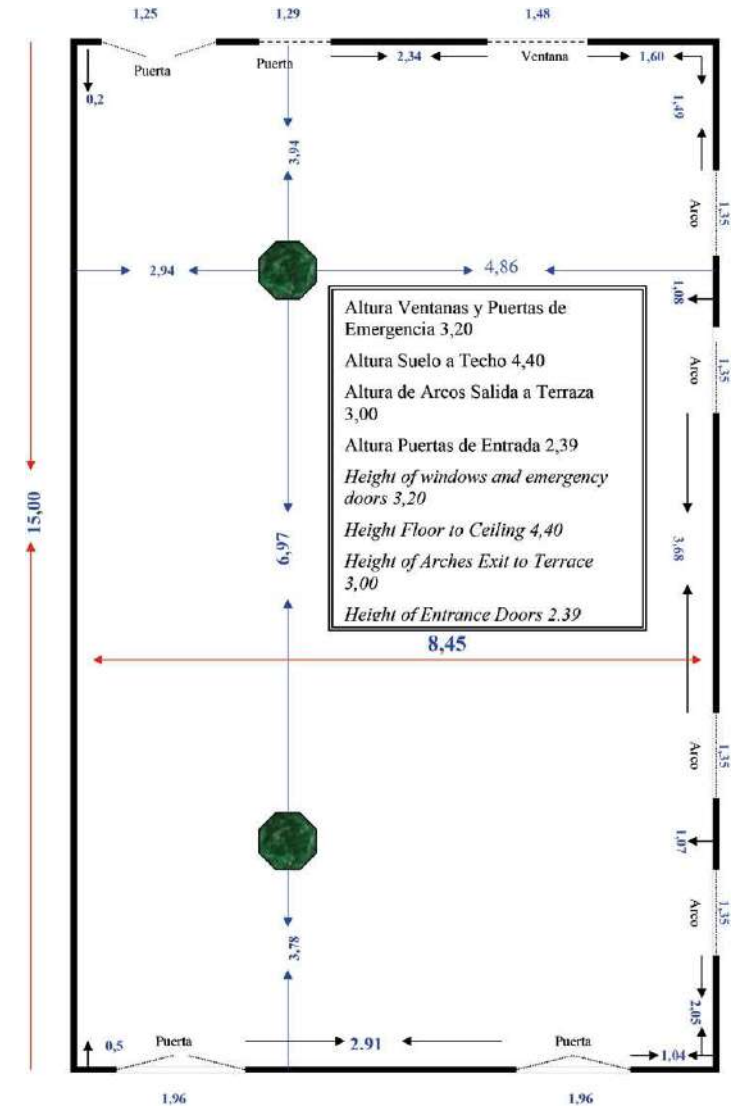

# Salón Árabe

MEETING ROOMS	HEIGHT (M.)	AREA (M <sup>2</sup> )
Árabe	5.00	89

MEETING ROOMS	CAPACITY					
Árabe	 120	 40	 80	 92	 90	 42

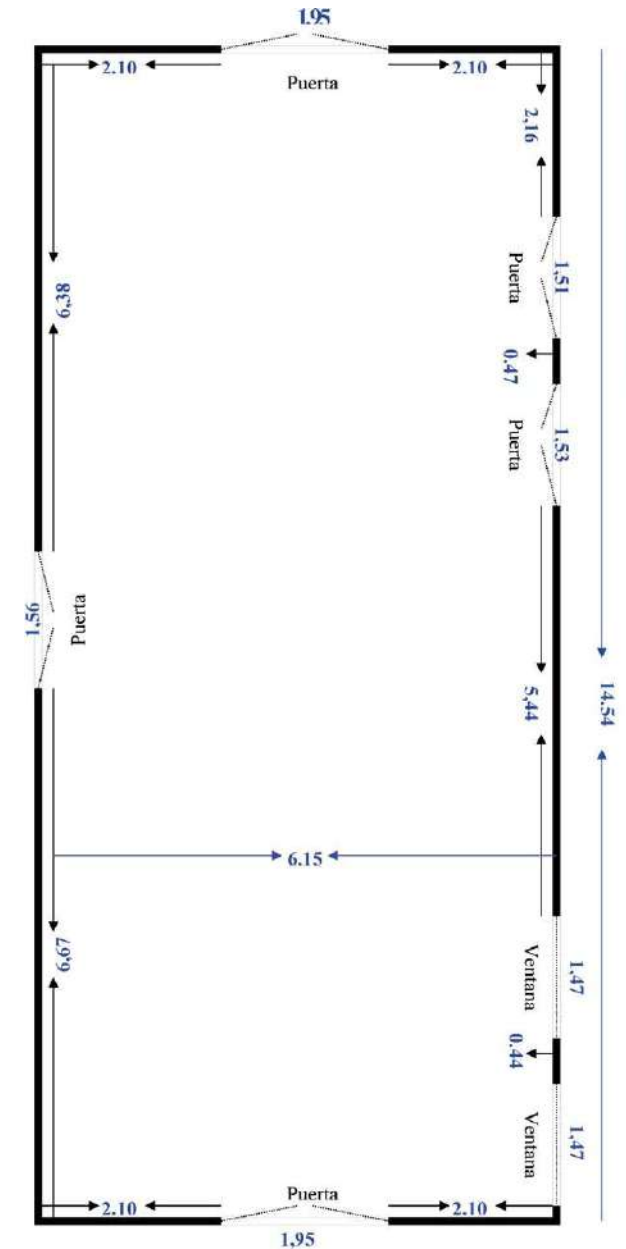

Altura Techo 4,70  
 Altura desde lámpara Central al suelo 2,32  
 Altura Hueco de Puertas 2,39  
 Ceiling height 4,70  
 Height from lamp Centre to floor 2,32  
 Height of door Door opening 2,39

# Teatro

MEETING ROOMS	HEIGHT (M.)	AREA (M <sup>2</sup> )
---------------	-------------	------------------------

Teatro	6.00	90
--------	------	----

MEETING ROOMS	CAPACITY					
---------------	----------	--	--	--	--	--

Teatro	 130	 35	 80	 84	 90	 -
--------	---	--	--	---	--	---



Medidas del arco del escenario: 5 metros de ancho y punto mas alto del arco 3,5.  
 Measurements of the stage arch 5 metres wide and the highest point of the arch 3.5 metres.

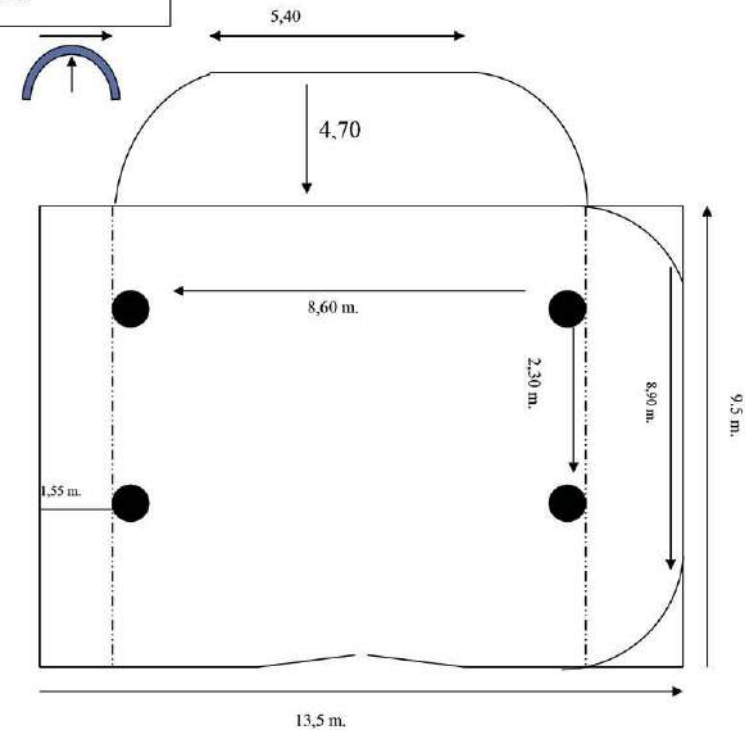

# Bar Azul y Salón Mirador

## MEETING ROOMS HEIGHT (M.) AREA (M<sup>2</sup>)

Terraza Mirador 4.24 127

## MEETING ROOMS CAPACITY

Terraza Mirador      

110 120 -

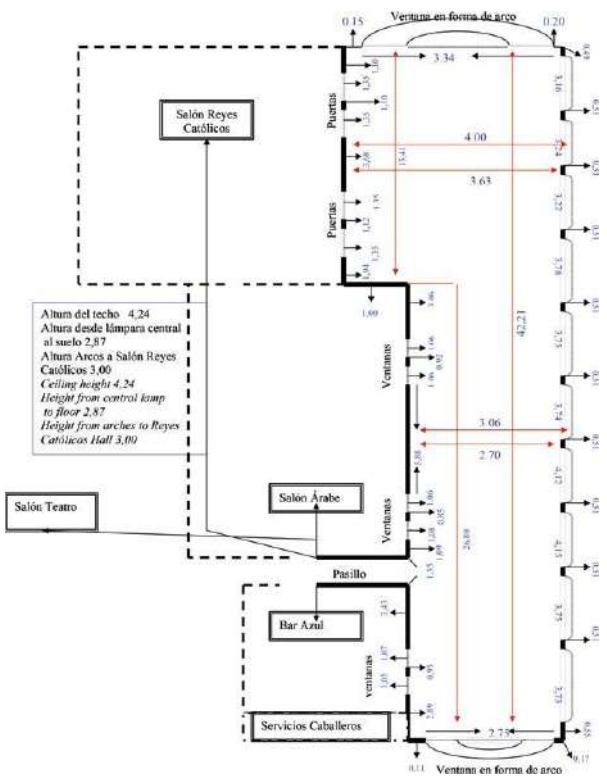



HOTEL  
ALHAMBRA PALACE  
- DESDE 1910 -  
★★★★★