

Host a More Memorable Meeting

Seamlessly combining a perfect downtown location with modern style and Southern hospitality, The Whitehall is Houston's premier address for meetings and social events accommodating up to 450 guests.

FIRST FLOOR

Lobby
Front Desk
Southern Host

Boardroom
Meeting Rooms
Part & Parcel Bar

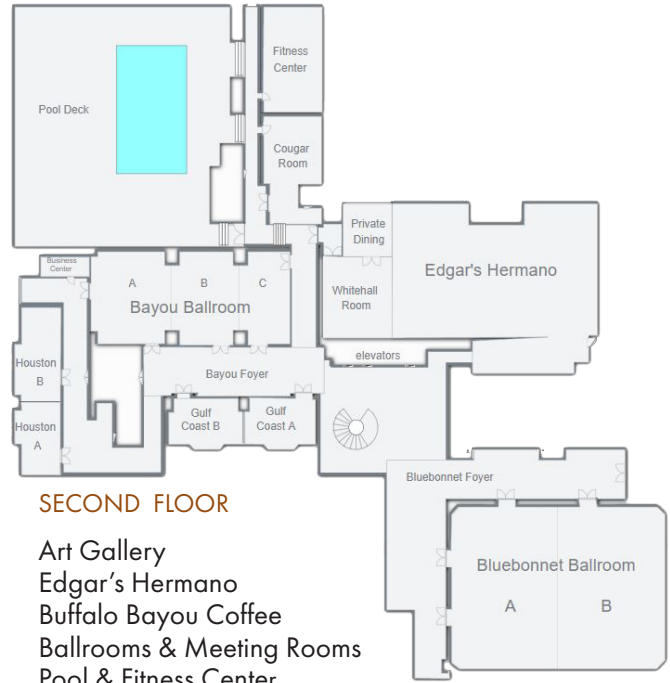
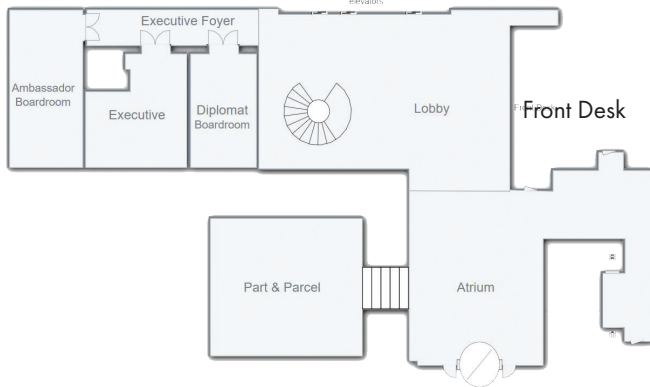

SECOND FLOOR

Art Gallery
Edgar's Hermano
Buffalo Bayou Coffee
Ballrooms & Meeting Rooms
Pool & Fitness Center

	Dimensions	Ceiling Height	Area (Sq Ft)	Theater	Classroom	Banquet	Conference	U-shape	Hollow Square	Reception
Bluebonnet Ballroom	57.8' x 77' x 12'	12'	4,233	450	270	280	60	72	84	350
Bluebonnet A	57.5' x 35.2' x 12'	12'	2,024	160	120	100	42	42	54	150
Bluebonnet B	57.5' x 41.8' x 12'	12'	2,403.5	220	120	140	42	42	54	200
Bluebonnet Foyer			2,130.9							
Bayou Ballroom	33.7' x 59.3' x 11.5'	11.5'	1,919.8	150	76	120	42	42	50	150
Bayou A/B	33.4' x 43.9' x 11.5'	11.5'	1,479.4	90	44	60	30	30	40	75
Bayou B/C	33.7' x 42.3' x 11.5'	11.5'	1,425.5	90	44	60	30	30	40	75
Bayou A	33.4' x 17' x 11.5'	11.5'	558.8	32	18	30	20	21		25
Bayou B	33.7' x 26.9' x 11.5'	11.5'	875.5	60	30	50	24	21	24	50
Bayou C	33.8' x 15.4' x 11.5'	11.5'	509.8	32	18	30	20	21		25
Bayou Foyer	24.4' x 63.4'	11.5'	1,546.9							70
Whitehall Room	35.9' x 28.6' x 15'	15'	1,026.7	70	40	60	24	26	32	50
Cougar Room	19.5' x 36.5' x 10'	10'	711.7	32	18	40	18	15	18	40
Gulf Coast A	16.8' x 28' x 10.8'	10.8'	470.4	40	18	20	18	15	20	25
Gulf Coast B	19.7' x 28' x 10.8'	10.8'	551.6	40	18	20	18	15	20	25
Houston A	16.8' x 26.9' x 10'	10'	451.9	32	12	20	18	15		20
Houston B	16.8' x 33.8' x 10'	10'	567.8	30	18	30	24	20		25
Ambassador	15.5' x 35.1' x 10'	10'	544	30	18	24	24	21		25
Executive	22' x 21' x 10.1	10'	462	30	15	20	12	12	12	20
Diplomat Boardroom	21.5' x 13' x 10'	10'	279.5				10			10
Executive Foyer	8' x 42.5' x 10'	10'	340							25