

2nd FLOOR

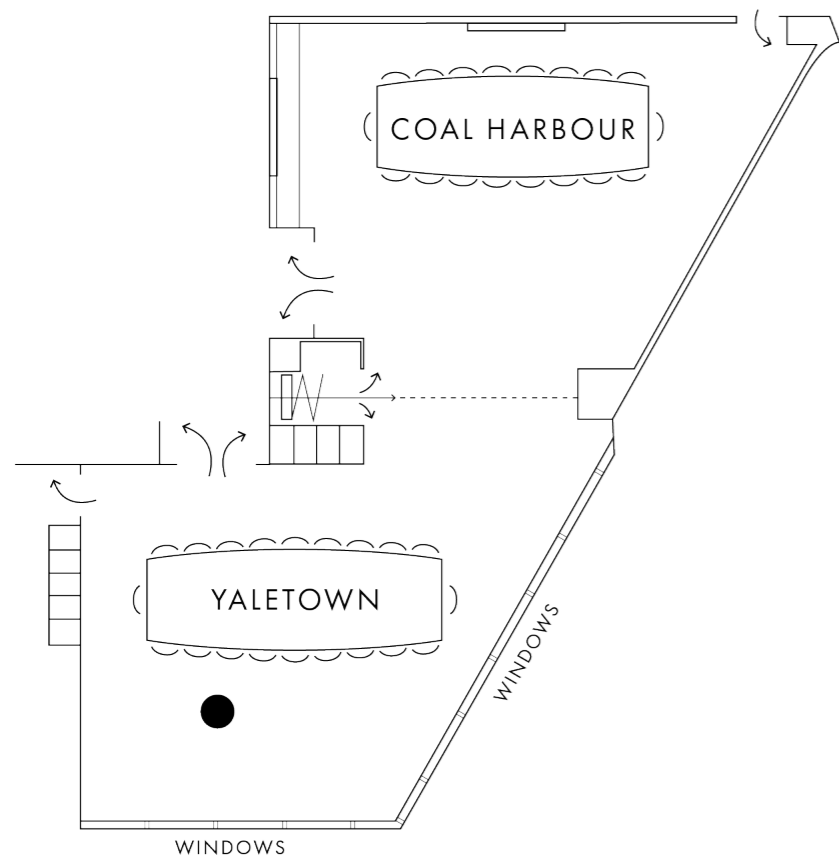

WEST GEORGIA STREET

3rd FLOOR

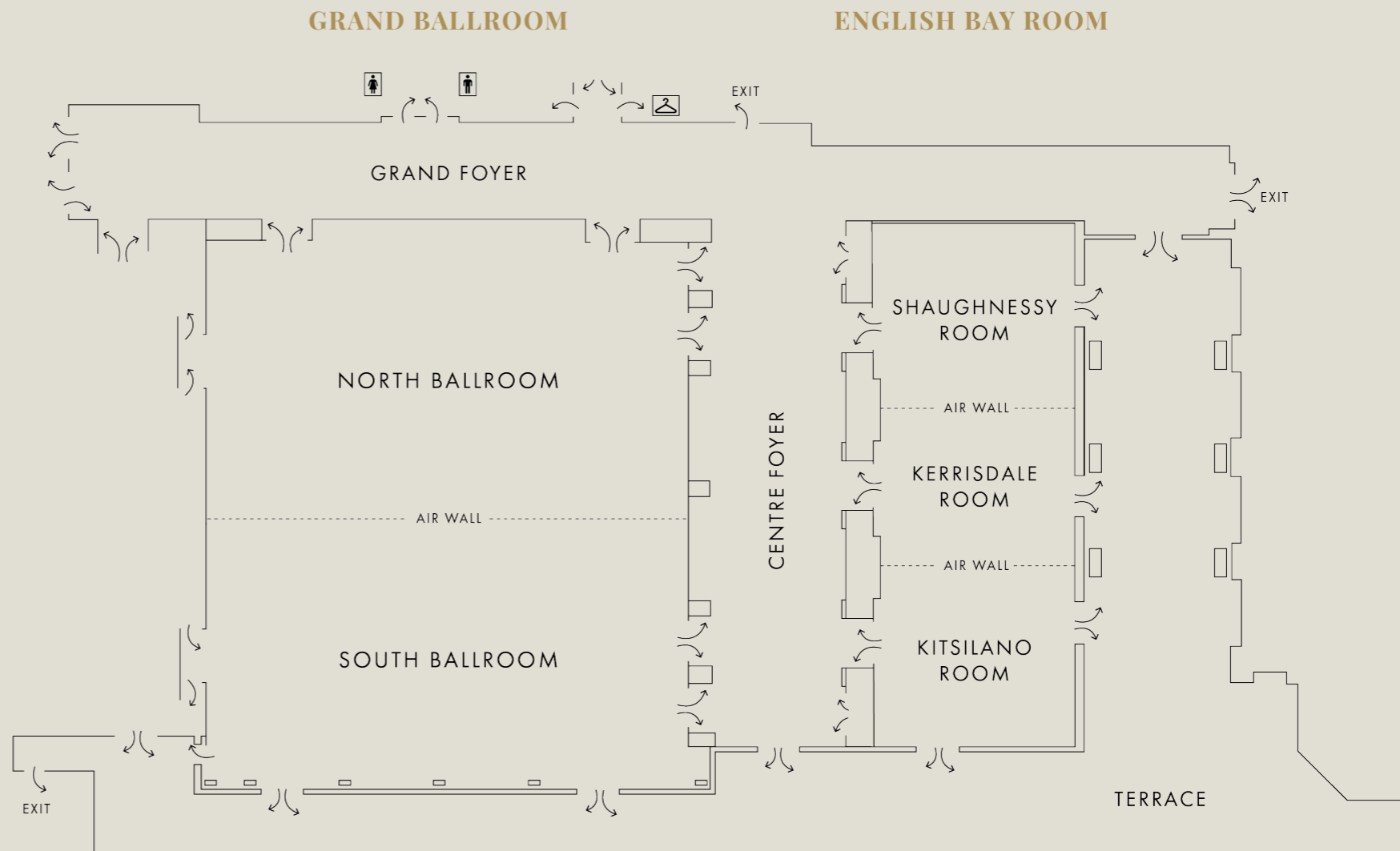

WEST GEORGIA STREET

Capacity CHARTS

ROOMS	TOTAL SQ FT	LENGTH X WIDTH	CEILING	RECEPTION	BANQUET	CRESCENT (ROUND OF 6/8)	THEATRE	CLASSROOM	U-SHAPE (3 PER 6')	HOLLOW SQUARE (3 PER 6')	BOARDROOM
THIRD FLOOR											
GRAND BALLROOM	5,360	80' x 67'	17'	500	360	240 / 320	500	270	-	-	-
• SOUTH BALLROOM	2,680	40' x 67'	17'	250	180	120 / 160	240	130	60	66	-
• NORTH BALLROOM	2,680	40' x 67'	17'	250	180	120 / 160	240	130	60	66	-
ENGLISH BAY ROOM	2,072	74' x 28'	11'	200	140	84 / 112	200	120	63	72	-
• KITSILANO ROOM	672	24' x 28'	11'	50	40	24 / 32	48	36	24	30	20
• KERRISDALE ROOM	672	24' x 28'	11'	50	40	24 / 32	48	36	24	30	20
• SHAUGHNESSY ROOM	672	24' x 28'	11'	50	40	24 / 32	48	36	24	30	20
• KITSILANO & KERRISDALE ROOM	1,344	48' x 28'	11'	120	80	48 / 64	96	72	48	54	40
• KERRISDALE & SHAUGHNESSY ROOM	1,344	48' x 28'	11'	120	80	48 / 64	96	72	48	54	40
FOYERS											
• CENTRE FOYER	1,530	90' x 17'	-	-	-	-	-	-	-	-	-
• GRAND FOYER	1,560	120' x 13'	-	-	-	-	-	-	-	-	-
WRAP-AROUND TERRACE	3,982	-	-	-	-	-	-	-	-	-	-
SECOND FLOOR											
YALETOWN & COAL HARBOUR ROOM	1,191	-	9'	100	70	42 / 56	-	-	-	-	-
YALETOWN ROOM	616	22' x 28'	9'	50	30	18 / 24	48	27	21	24	18
COAL HARBOUR ROOM	575	23' x 25'	9'	50	30	18 / 24	54	36	21	24	20