

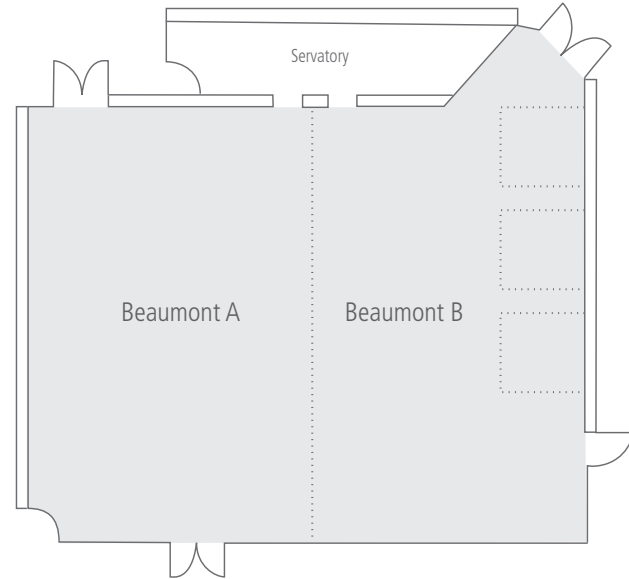

**Main Floor**

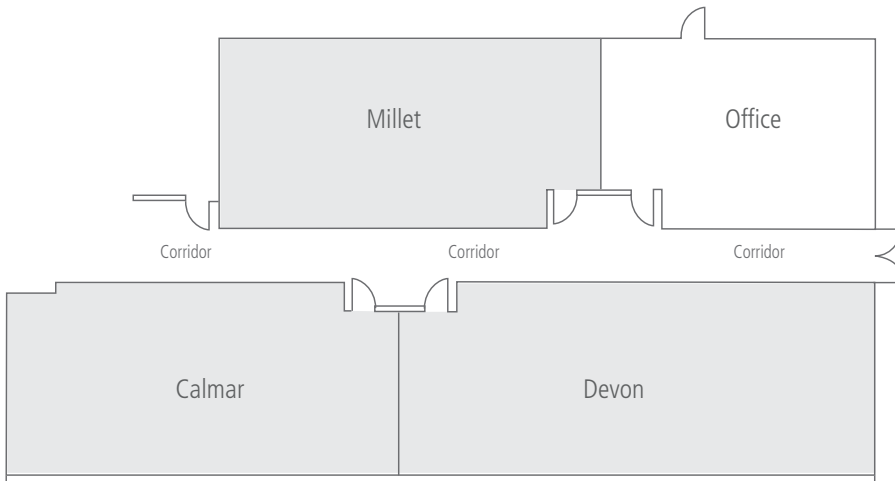

**Room specifications**

Meeting Room	Theatre	Classroom	U-Shape	Hollow Square	Boardroom	Half Rounds	Crescent Rounds	Rounds	Sq.Ft
<b>MILLET</b>	60	20	20	24	16	N/A	N/A	N/A	738
<b>CALMAR</b>	60	24	24	26	20	N/A	N/A	N/A	810
<b>DEVON</b>	60	30	28	26	20	N/A	N/A	N/A	852
<b>BEAUMONT A &amp; B</b>	150	80	40	46	40	72	80	120	2260
<b>BEAUMONT A</b>	70	32	24	30	24	30	40	50	1120
<b>BEAUMONT B</b>	80	36	30	36	24	30	40	50	1140

*connect with our sales and catering team*

1101 4th St., Edmonton, AB T9E 7N1

[sales@coastniskuinn.com](mailto:sales@coastniskuinn.com) t. 1.780.955.7744 ext. 2



# COAST

nisku inn & conference centre™

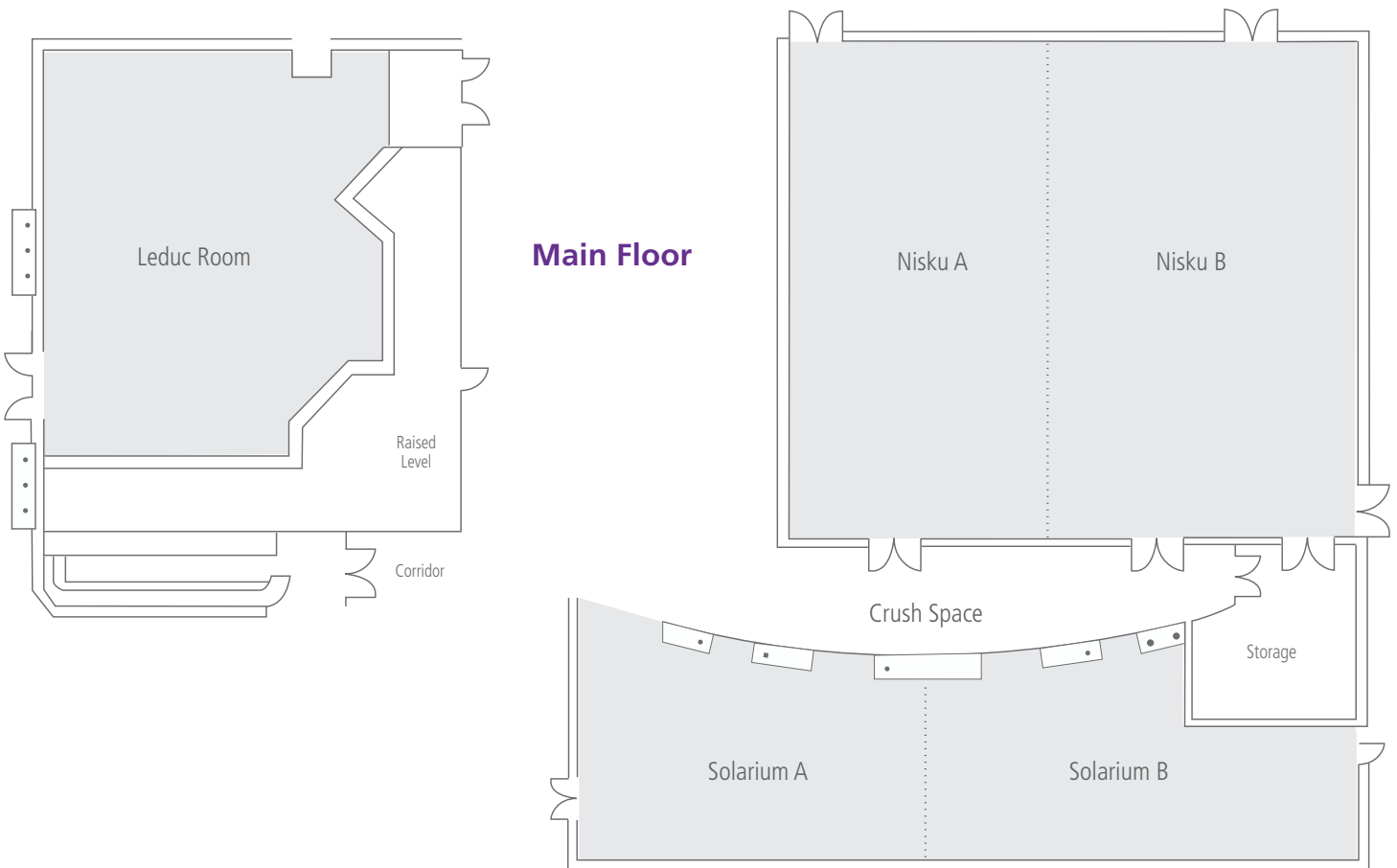

## Room specifications

Meeting Room	Theatre	Classroom	U-Shape	Hollow Square	Boardroom	Half Rounds	Crescent Rounds	Rounds	Sq.Ft
NISKU BALLROOM	668	246	100	110	N/A	210	280	350	6040
NISKU A	368	130	50	60	30	60	80	100	2725
NISKU B	300	100	50	60	30	84	96	140	3315
SOLARIUM	150	110	60	66	50	96	128	160	2850
SOLARIUM A	70	50	36	40	24	48	64	80	1425
SOLARIUM B	70	50	36	40	24	48	64	80	1425
LEDUC ROOM	120	60	46	50	30	60	80	100	2740

**connect with our sales and catering team**

1101 4th St., Edmonton, AB T9E 7N1

sales@coastniskuinn.com t. 1.780.955.7744 ext. 2