



coast coal harbour vancouver hotel by APA
arranging an event has never been easier











Host a memorable meeting or event and enjoy our urban style hotel concept unique to the city

Coast Coal Harbour Vancouver Hotel by APA has over 8,000 square feet of meeting space including a modern ballroom with 20-foot-high ceilings and floor-to-ceiling windows. With 220 guest rooms, this zero-waste, green hotel is the perfect venue for meetings and events up to 360 guests.

Enjoy signature APA in-room comforts including Electric Bidet Seat (TOTO® Washlet), 55" flat screen TV and traditional welcoming origami cranes. After a day of meetings or exploring the neighbourhood, join us for a meal or snack at Prestons Restaurant + Lounge.

Guests will appreciate our close proximity to Vancouver Convention Centre, Gastown, and the famous Robson Street shopping.

amenities

 Free Wi-Fi	 Prestons Restaurant + Lounge
 Meeting and banquet space	 Outdoor Pool & Fitness Centre
 Electric bidet seat – TOTO® Washlet	 55" flat screen TVs
 Secure valet parking & electric car charging stations	 Pet-friendly rooms

local gems

 Local Mountains	 Nearby shopping districts
 Stanley Park	 Coal Harbour seawall



coast coal harbour sales & catering
 ccc.sales@coasthotels.com
 t. 604.697.0202

Make Your Next Event Extra Rewarding!
 **AEROPLAN**  **coast rewards™**

the perfect venue for your meetings, events and celebrations

Third Floor - 3F

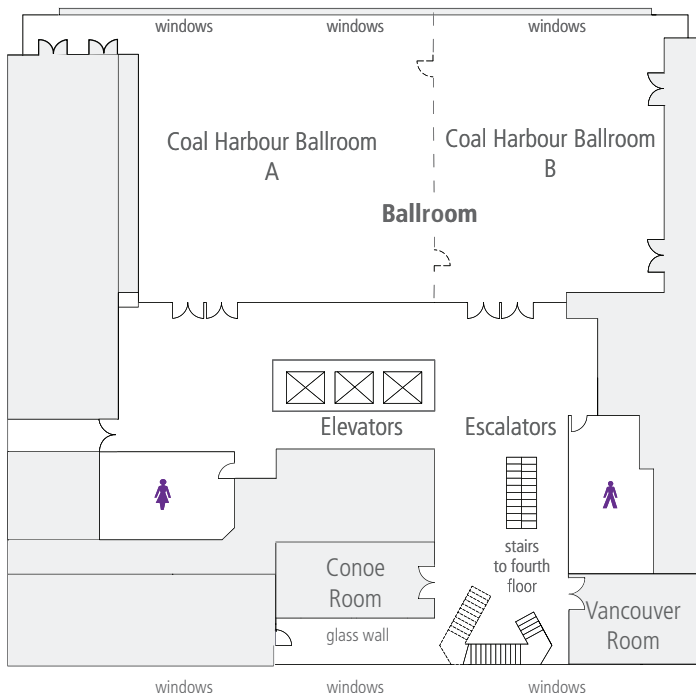

Fourth Floor - 4F

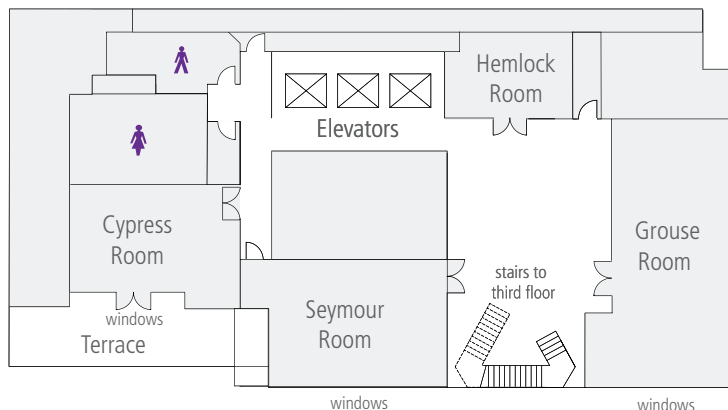

Room Specifications

Meeting Room	Theatre	Classroom 2 per table	Classroom 3 per table	Boardroom	Rounds of 6	Rounds of 8	Reception	U-Shape	Hollow Sq.	Ceiling Height
COAL HARBOUR BALLROOM	500	224	336	–	216	288	500	–	–	20'
COAL HARBOUR A	300	128	192	–	120	160	300	60	70	20'
COAL HARBOUR B	200	96	144	–	96	128	200	50	60	20'
CONOE	–	–	–	16	–	–	–	–	–	9'
VANCOUVER	25	12	15	14	12	16	15	–	–	10'
GROUSE	80	32	48	38	42	56	70	34	32	9'
SEYMOUR	40	24	36	20	24	32	50	20	22	8'6"
CYPRESS	24	14	21	16	18	16	30	16	18	9'
HEMLOCK	12	8	12	8	6	8	–	–	–	8'10"

Please note the capacity is the maximum for each space and does not account for AV set up, dance floors, DJ, photo booths, bars, and buffets. Wider aisles are required for wheelchair, staging, and ramp access.