



Unparalleled Hospitality • Elegant Accommodation • Renowned Cuisine

INTRODUCTION

Goodwood Park Hotel is a celebrated institution in hospitality circles, truly one of the most endearing pioneers of the tourism industry. Built in 1900, the Hotel began life as the Teutonia Club – an exclusive enclave for the expatriate German community in Singapore. She has withstood the ravages of time and survived two World Wars.

Today, Goodwood Park Hotel is Asia Pacific's distinguished heritage hotel. Much of her original beauty has been faithfully restored, with her Grand Tower gazetted a national monument in 1989. The hotel has tastefully appointed rooms and suites complete with the comfort of contemporary amenities, 2 outdoor swimming pools, a fitness centre, 5 distinctive restaurants, a bar and a deli.

A national landmark sited on a lush 6-hectare landscaped garden hillock within Singapore's famed shopping belt in Orchard and a mere 10-minute drive to the Central Business District, Goodwood Park Hotel continues to attract businessmen and leisure-seekers from all over the world.



Teutonia Club in 1900

Protecting the well-being of our guests and staff remain paramount as always. Goodwood Park Hotel is proud to be certified as a SG Clean establishment by the Singapore Government with our hygiene and sanitation measures officially inspected and endorsed by appointed assessors. We are committed to ensuring a safe and clean environment for everyone as well as providing peace of mind for our guests' experience.



Main Pool

FACILITIES & SERVICES

- Business Centre
- Fitness Centre
- Swimming Pools (Main & Mayfair)
- 24-hour Room Service
- Concierge
- Beauty & Spa Services
- Same-day Laundry, Dry Cleaning & Pressing Services
- Tang Treasures Suite (Gallery)



Rose Marie Suite

ACCOMMODATION

AMENITIES

Be pampered with practical facilities and amenities in the signature gracious hospitality of Goodwood Park Hotel.

Each room & suite in the Lobby, Mayfair & Tower Wing comes with:

- Complimentary internet access (wired & wireless)
- Air-conditioning & ceiling fan
- Cable & satellite TV
- Coffee & tea making facilities (Nespresso machine in suites)
- Minibar
- Bathroom toiletries
- Hairdryer, bathrobe & bedroom slippers
- Iron & ironing board
- Personal safe
- IDD telephone & voicemail facility
- 230-volt electrical outlets



TYPES OF ROOMS & SUITES

The tastefully appointed rooms and suites, dotted within the lovely 6-hectare compound, are housed in several wings - Lobby, Mayfair, Tower and Parklane.

The unmistakable allure of these charming enclaves is further augmented by the individual contemporary finishing, which adds a touch of exclusivity and uniqueness to a heritage hotel in a distinct class of its own.

Deluxe Mayfair Room

Each room presents a charming décor with a balcony overlooking the Balinese-inspired Mayfair Pool or the surrounding greenery.

Size: 31 - 44 sqm

No. of Rooms: 66

Deluxe Premier Room

Spacious and inviting, each room strikes a comfortable balance between sleek sophistication and warm elegance.

Size: 39 sqm

No. of Rooms: 44

Deluxe Poolside Room

This cosy room accentuated with classy design elements, opens out to a small patio next to the Balinese-inspired Mayfair Pool.

Size: 31 sqm

No. of Rooms: 8

Heritage Room

Located in the heritage Tower Wing. Well-appointed and infusing modernity with neo-classical charm, the bedroom and sitting area exude a comfortable elegance.

Size: 36 - 48 sqm

No. of Rooms: 15

Junior Suite

Timeless design aesthetics and a luxe residential vibe feature in this space comprising a bedroom and a separate living area.

Size: 50 - 65 sqm

No. of Rooms: 14

Poolside Suite

Comfort and impeccable style blend seamlessly in this suite with a living room that opens out directly to the Main Pool.

Size: 48 - 55 sqm

No. of Suites: 13

Deluxe Poolside Suite

An enchanting sanctuary featuring a living room, 2 bathrooms and a bedroom with direct access to the Balinese-inspired Mayfair Pool.

Size: 65 sqm

No. of Suites: 5

1-Bedroom Suite

This spacious suite with separate sitting and dining room areas, exude a quiet sophistication with views of the beautiful Mayfair Pool. Each bedroom has a small balcony.

Size: 90 sqm

No. of Suites: 1 - 2

2-Bedroom Suite

This spacious suite with separate sitting and dining room areas, exude a quiet sophistication with views of the beautiful Mayfair Pool. Each bedroom has a small balcony.

Size: 121 sqm

No. of Suites: 1 - 2

Rose Marie Suite

Exuding the grandeur of an aristocratic mansion, this suite features a spacious lounge, leather-panelled study, luxurious bedroom with a walk-in closet, bathroom with sauna, pantry and a grand dining room with its own rooftop terrace.

Size: 260 sqm

No. of Suites: 1

Parklane Suite

Housed in an annexe building to the hotel, these split-level apartment-style suites are designed specially for long stays, complete with practical amenities and facilities. There are 2 types of Parklane Suites to cater to different guest needs.

Split Level Studio Suite: 600 sqft (55.74 sqm)

One bedroom on the upper level with sitting-cum-dining area, kitchenette, bathroom and balcony on the lower level.

No. of Suites: 32

Split Level Suite: 800 sqft (74.32 sqm)

Sitting-cum-dining area, kitchenette and balcony on one level with one bedroom and bathroom on the upper level.

No. of Suites: 32

For Room Reservations:

Telephone: +65 6730 1811 / 1844

Email: rmresv@goodwoodparkhotel.com



Junior Suite



Poolside Suite



Mayfair Pool



Deluxe Poolside Suite



Parklane Suite

FOOD & BEVERAGE OUTLETS

Goodwood Park Hotel has come to be fondly known for the signature fare and original creations that are still pleasing palates today. Our seven food & beverage establishments offer dining choices that range from casual simplicity to fine gastronomy.

From the unique meat trolley service that is Gordon Grill's pride to the savoury Chinese delicacies at Min Jiang to the authentic Beijing Duck in Min Jiang at Dempsey and the famous English Afternoon Tea at L'Espresso, as well as the tasty traditional Taiwan Porridge at Coffee Lounge and the irresistible seasonal Durian Puffs and Mooncakes at The Deli, there is always something to cater to the discerning diner in you.



Coffee Lounge
+65 6730 1746

An enclave with colonial architectural charm famed for its extensive Taiwan Porridge menu and local fare.

Seating Capacity 120 pax

Breakfast 6am - 10.30am
Lunch 12noon - 2.30pm
Dinner 6pm - 10.30pm

Late Afternoon Dining 2.30pm - 6pm



L'Espresso
+65 6730 1743

Offers delightful lunch and dinner menus, ever-popular English Afternoon Tea and cocktails in the evenings.

Seating Capacity 68 pax (indoor)
70 pax (outdoor)

Operating Hours 11am - 7pm

English Afternoon Tea Buffet
with Local Favourites

(Mon to Fri) 12noon - 2.30pm (1st seating)
3pm - 5.30pm (2nd seating)
(Sat to Sun & PH) 11am - 1pm (1st seating)
1.30pm - 3.30pm (2nd seating)
4pm - 6pm (3rd seating)



The Deli
+65 6730 1786

Indulge in a mouthwatering array of cakes, pastries and homemade cookies.

Operating Hours 11am - 7pm

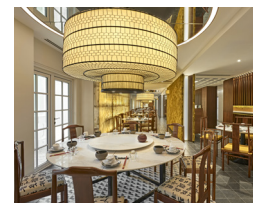

Min Jiang
+65 6730 1704

Features Cantonese and Sichuan delicacies, including a classic dim sum pushcart service during lunch daily.

Seating Capacity 100 pax (indoor)
60 pax (6 private rooms)
70 pax (outdoor)

Lunch & Dim Sum
(Mon to Fri) 11.30am - 2.30pm
(Sat & Sun) 11am - 2.30pm

Dinner 6.30pm - 10.30pm



Gordon Grill
+65 6730 1744

Renowned for serving some of the finest steaks and Continental cuisine in Singapore.

Seating Capacity 60 pax

Lunch 12noon - 2.30pm
Dinner 6.30pm - 10pm



Min Jiang at Dempsey
(7A & 7B Dempsey Road)
+65 6774 0122

Set amidst the luscious greens of Dempsey Hill, in a colonial building, the house specialities include the Wood-fired Beijing Duck, exquisite dim sum as well as the classic Sichuan and Cantonese delicacies.

Seating Capacity 130 pax (indoor)
20 pax (outdoor)
8 pax (bar)

Lunch 11.30am - 2.30pm
Dinner 6.30pm - 10.30pm



Highland Bar
+65 6730 1744

Ideal for aperitifs, after-dinner drinks and cocktails.

Seating Capacity 20 pax (sitting)
40 pax (standing)

Operating Hours 11am - 11pm

Due to the Covid-19 situation, seating capacity and operating hours may differ.
For online reservations, please visit www.goodwoodparkhotel.com

CATERING

Goodwood Park Hotel is experienced in handling a variety of events from large corporate seminars or embassy/government functions to weddings, theme parties and business meetings, tailored towards each organiser's needs. The largest and grandest banqueting space is the Windsor Ballroom which is designed in a unique octagonal shape that symbolises good luck in 'feng shui'. For smaller business meetings or breakout sessions, the Windsor Ballroom can be divided into 2 or 4 separate rooms. The charming Tudor Ballroom caters for events on a smaller scale, offering a private reception foyer and natural daylight. The Tudor Courtyard, an elegant glass marquee framed by manicured green walls, is a perfect venue for wedding solemnisations, cocktail events or corporate lunches and dinners.

Special Features:

All conference and function rooms feature modern teleconferencing and audio-visual equipment, including:

- Broadband internet access (wireless) in all function rooms
- Strategically positioned motorised projectors and screens in all function rooms

Function Rooms (1st Floor)	Seating Capacity										Dimension			
	Theatre	Classroom (3 pax/table)	Boardroom	U-Shape	Cluster (Rds of 6)	Cocktail	Chinese (Rds of 10)	Buffet (Rds of 10)	Western (Rds of 8)	Hollow Square	Floor Area (Sq Ft)	Length (Ft)	Width (Ft)	Height (Ft)
Tudor Ballroom	230	120	40	42	96	230	220	220	160	54	2564	63.7	40.3	10.8
Tudor Courtyard	150	-	-	-	-	140	-	80	-	-	2583	65.61	39.37	13
Boardroom I	-	-	10	-	-	-	-	-	-	-	255	26.15	12	9.8

Function Rooms (2nd Floor)	Seating Capacity										Dimension			
	Theatre	Classroom	Boardroom	U-Shape	Cluster (Rds of 6)	Cocktail	Chinese (Rds of 10)	Buffet (Rds of 10)	Western (Rds of 8)	Hollow Square	Floor Area (Sq Ft)	Length (Ft)	Width (Ft)	Height (Ft)
Arundel / Dover / Hampton / Leeds	50	30	20	24	30	40	50	50	40	30	1001	42.3	32.1	14.8
Arundel & Dover / Hampton & Leeds	100	60	40	36	60	80	100	100	80	54	2002	84.6	64.2	14.8
Windsor Ballroom	400	300	-	-	204	350	380	280	288	-	5759	73.8	86.9	14.8
Boardroom II	-	-	10	-	-	-	-	-	-	-	331.5	25.5	13	9.8

1 Square Metre = 10.764 Square Feet, 1 Metre = 3.28 Feet



Tudor Courtyard

BESPOKE CATERING SERVICE – YOU INVITE THE GUESTS, WE’LL DO THE REST

The Hotel has a professional and dedicated off-premises catering service to assist all event and party planners in achieving lasting impressions for all occasions. To make every event a success, clients will be taken through the entire planning experience, covering details such as music and floral arrangements, as well as choosing the right cuisine with complementary table settings.

We bring our chefs and our service team to wherever your party is held. Whether it is a garden party, a business breakfast or a formal dinner, we have a menu and even a team of white-gloved butlers for you! Our culinary team is able to prepare an array of specialty menus, backed by experienced chefs from award-winning restaurants, Min Jiang and Gordon Grill.

For Banquet / Outside Catering:

Telephone: +65 6730 1821 Email: banquet@goodwoodparkhotel.com

WINDSOR BALLROOM

With its mirrored wall panels, high coffered ceiling with crystal chandeliers and magnificent layout unobstructed by any pillars, the unique octagonal Windsor Ballroom is a visually impressive venue. The ballroom can also be partitioned into 2 or 4 separate rooms.

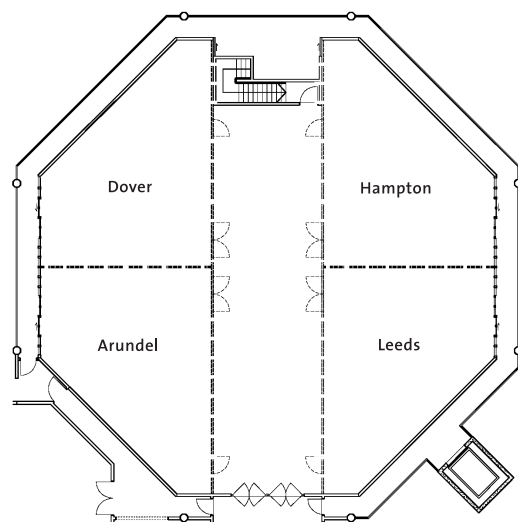

TUDOR BALLROOM

Delicately luxe with chandeliers, colonial-style décor in a soothing cream palette, the Tudor Ballroom exudes a cosy and inviting charm. The rectangular ballroom features floor-to-ceiling windows on both sides, allowing natural daylight in. Its private reception area provides a perfect setting for pre-event cocktails.

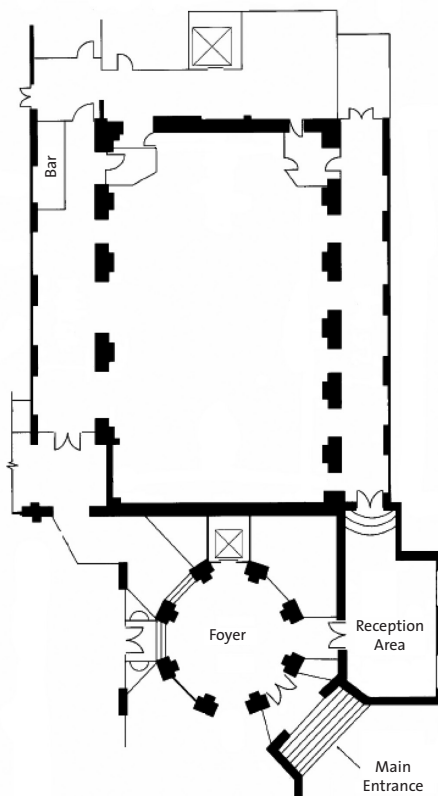

CONTACT DETAILS

GENERAL MAP

Conveniently located in the heart of the shopping and entertainment hub of Orchard and Scotts Road, the Hotel is 10 minutes from the main banking and business district of Shenton Way; making it an ideal choice for both leisure and business travellers. Travel via taxi to Singapore Changi International Airport takes approximately 25 minutes.

GOODWOOD PARK HOTEL
22 Scotts Road Singapore 228221

TELEPHONE +65 6737 7411
FACSIMILE +65 6732 8558
enquiries@goodwoodparkhotel.com
www.goodwoodparkhotel.com

MEMBER OF THE GOODWOOD GROUP OF HOTELS

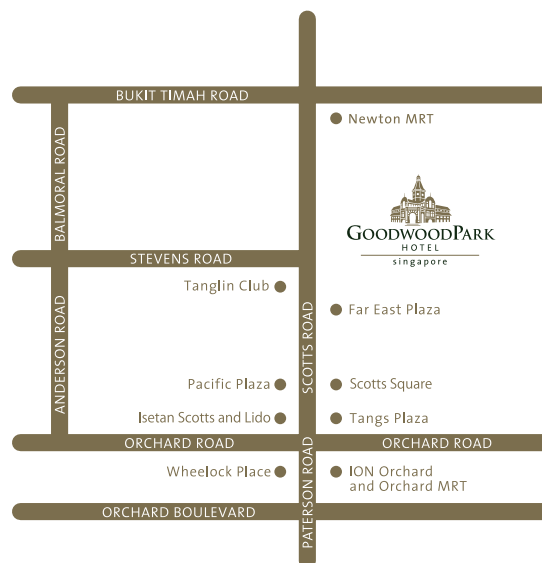

AWARDS & ACCOLADES

SG Clean Certified Establishment – Hotel
Singapore Tourism Board & Enterprise Singapore

BCA Green Mark Award - Gold
Building and Construction Authority

Excellence in Service - Hotel
Singapore Tourism Board

Excellent Service Awards - Silver, Gold, Star
Singapore Hotel Association

Certificate of Excellence & Travelers' Choice Award
TripAdvisor

National Courtesy Award - Service Gold
Singapore Hotel Association &
Singapore Kindness Movement Council

Gold Circle Award - Hotel
Agoda.com

Loved by Guests Award Winner - Hotel
Hotels.com

Recommended Award - Hotel
Forbes Travel Guide

Hotel Security Award
Singapore Hotel Association

Best Afternoon Relaxation - Finalist
HotelClub

Top 5 Restaurants - Singapore Service Star
(Gordon Grill)
Singapore Tourism Board

Recommendations
(Hotel, Gordon Grill, Min Jiang)
Michelin Guide Singapore

Regional Best Restaurants Guide
(Gordon Grill, Min Jiang)
Asia Tatler

Singapore's Best Restaurants
(Gordon Grill, Min Jiang)
Singapore Tatler

Best Restaurant - Chinese Cuisine
(Min Jiang)
Hospitality Asia Platinum Awards

Best Restaurant - Western Cuisine
(Gordon Grill)
Hospitality Asia Platinum Awards

Awards of Excellence
(Gordon Grill)
Gourmet & Travel G Restaurant Awards

Best Business Lunch (Western)
(Gordon Grill)
Gourmet & Travel G Restaurant Awards

Singapore's 50 Yummiest Cakes
(Durian Mousse Cake)
The Sunday Times

Singapore's Best Durian Puffs
Lianhe Wanbao

and more