

TITANIC

DELUXE LARA

CONCEPT
2023



TITANIC HOTELS

The Titanic Hotels Group story began in 1993, but the real foundations of the 'TITANIC' brand were laid in 2003 when the ship-themed Titanic Deluxe Lara Hotel opened in Lara, Antalya.

The opening of the Titanic Deluxe Lara signified the AYG Group's intention to expand and invest in the hotel sector. Buoyed by the success and synergy created by this new brand, the group decided to bring all their existing and future hotels under the umbrella of the TITANIC brand.

TITANIC HOTELS SUB-BRANDS

When it comes to operations and investments, the AYG group determine the sub-brands and concepts of their hotels according to the location and physical structure of the site.

The unique and exclusive service offered by Titanic Hotels is the result of years of experience. The hotels, which meet internationally recognised standards, are classified as follows.

PALACE HOTELS

Palace Resort

Palace City

DELUXE HOTELS

Deluxe Resort

Deluxe Golf

Deluxe City

BEACH RESORTS

BUSINESS HOTELS

PORT HOTELS

CITY HOTELS

COMFORT HOTELS

TITANIC HOTELS KEY FEATURES

Optimum location for its category

Outstanding professionalism in hotel management

Focus on guest satisfaction and superior service level

Guarantee of first-class materials used in every product

Premier quality food and drink concept in its category,

Compliance with stringent international hygiene standards,

Commitment to the philosophy of Total Quality with sustainable management

Utmost emphasis on guest health and safety

Rigorous Environmental Awareness,

Support and participation in social projects,

Energy-efficient service concept,

Exceptional and uninterrupted free WI-FI provision.

TITANIC HOTELS PANDEMIC MEASURES

Following the Covid 19 pandemic that began in 2020 and spread across the whole world, all TITANIC HOTELS premises immediately adopted measures to protect against this, and future, epidemics.

We always keep up-to-date with the latest instructions, recommendations and publications from The World Health Organisation (WHO), the health ministries of the Republic of Turkey and the Federal Republic of Germany and other public sector institutions, relevant professional organisations and scientific bodies.

Furthermore, the 'Hygiene and Health Procedure' meticulously followed in all TITANIC HOTELS has been reviewed, resulting in the introduction of the 'SAFE TOUCH' concept.

All our premises have 'SAFE TOURISM' accreditation, which is awarded by international auditing bodies and subject to regular, ongoing checks.



TITANIC
HOTELS

ANTALYA | ISTANBUL | BODRUM | BERLIN





GENERAL INFORMATION

Opening Date: May 2003

Category: Beach Resort 5-Star

Company: Aygün Turizm İnşaat San. Tic. A.Ş

Season: 12 Months

Total Space: 95.000 m²

Beach: 12.000 m² (Sand and grass)

Concept: Deluxe All Inclusive

Address: Kopak Çayı Mevkii, Lara / Antalya

Tel: +90 242 352 02 02 (03, 04)

Fax: +90 242 352 02 00

e-Mail: beachlara@titanic.com.tr

Web: titanic.com.tr



LOCATION AND ACCESS

| | |
|-------------------|-------------------------|
| Antalya Centre | 12 km |
| Antalya Airport | 10 km |
| Transport Options | VIP Transfer, Taxi, Bus |

* Pets not allowed.

* Use of skateboards, skates, scooters and hoverboards is not allowed in the indoor areas of the hotel.

* Use of drones is not allowed.

*** The Titanic Deluxe Lara reserves the right to make concept changes without informing second and third parties/organisations.

Situated in the Lara resort area of Antalya, one of the greatest holiday destinations in Turkey and the world, the Titanic Deluxe Lara is right on a beach that has become famous for its outstanding therapeutic sands. Its location, only 15 minutes from Antalya International Airport and 20 minutes from the centre of the resort, make it the most sought-after hotel in Lara.

Complete with meeting and congress rooms, football pitches, spacious rooms and an extensive beach, the hotel is an extremely popular, well-loved family destination offering fantastic experiences 12 months of the year.

ABOUT OUR CONCEPT

At Titanic hotels, we offer you, our valued guests, traditional Turkish hospitality and the benefit of our many years of experience. Building on this, our 2022 service is centred around the DELUXE INCLUSIVE CONCEPT, carefully curated especially for the TITANIC DELUXE LARA. Please see more details below.



WELCOME AND FAREWELL

| | |
|--|--|
| Doorman, Valet and Bellboy services | Free Parking |
| Luggage Sanitation | Special welcome for guests with disabilities |
| Sanitised welcome and farewell packs | Room key and site guide presented in special, sanitised container. |
| Fast and hygienic check-in, check-out and site introduction procedures | Welcome at the door with special drinks |

GUEST ASSISTANCE SERVICE

Guests staying in special room types (Colonel Suite, Admiral Suite) have a designated assistant. Our guests can contact their special assistant about anything throughout their stay.

GUEST CALL CENTRE

Our Guest Call Centre is open to all guests between 08:00 and 00:00. During check-in, guests are given the Call Centre number and asked to provide their own mobile phone number. Once check-in is complete, guests receive a 'WELCOME' message from the staff unit responsible for ensuring that all guest wishes and requests are quickly dealt with. They also share regular updates so that guests can take maximum advantage of all the hotel has to offer.

VALID CREDIT CARDS

| | | | |
|--|------------|----------|------------------|
| Visa | MasterCard | Eurocard | American Express |
| Payment by instalment is only possible for sales made via our Call Centre. | | | |

LANGUAGES SPOKEN

| | | | |
|---------|---------|--------|---------|
| Turkish | English | German | Russian |
| Dutch | Arabic | | |

SHOPPING FACILITIES

| | | | |
|----------------------|--------------------------|--------|--------------|
| Shoes and Bags | Boutique for Men & Women | Market | Jewelry |
| Souvenirs & Trinkets | Kid's Boutique | Silver | Photographic |
| Sportswear | Leather | | |

CHARGED SERVICES

| | | | |
|---|---|---|---|
| Washing and Dry Cleaning service | Late check-out and Early check-in | Room Service | Premium and luxury drinks not included in the concept |
| Imported alcoholic beverages served by bottle | Premier wines served by a sommelier in à la carte restaurants | Cabana rental and special all-day services at the beach and pools | Box rental with special all-night services at the Show Centre |
| Baby Stroller, Baby Monitor | Wheelchair | Doctor Services | Spa Therapy and Wellness Services |
| Photocopying, printing service | Luggage Packing service | | |

OUR HONEYMOON CONCEPT

| | |
|---|---|
| The best room in its category according to hotel availability | Fresh flowers in the room |
| Complimentary sparkling wine, fruit platter, cake and Turkish sweets on arrival | Gift heart-design cushion |
| VIP amenities set | Priority for à la carte reservations, Table decorations |
| Complimentary traditional Turkish breakfast served to the room on your chosen day | Complimentary Italian or fish meal in an à la carte restaurant. |
| 20% off BeFINE spa treatment prices | |



ACCOMMODATION

ROOM TYPES DESCRIPTION

| Room Types | Location | Features | Max. Capacity |
|---------------------------|--|---|-------------------|
| Standard Room | Main Building 26 m ² | Situated in the main building, standard rooms are 26 m ² and include twin or French beds, sitting area, bathroom, minibar, TV, satellite and music channels, Wi-Fi connection, direct telephone, central air conditioning, safe, shower, hair dryer, tea and coffee set-up, carpeted floor and balcony. There are 7 standard rooms especially designed for guests with disabilities. | 2+2 (3 adults) |
| Anex Standart Garden Room | Garden 26 m ² | Situated in 2 buildings in the garden, Annex Standard Garden Rooms are 26 m ² and include twin or French beds, bathroom, minibar, TV, satellite and music channels, Wi-Fi connection, direct telephone, central air conditioning, safe, shower, hair dryer, tea and coffee set-up, carpeted floor and balcony. | 2+1 |
| Annex Standard Pool Rooms | Garden 26 m ² | Situated in 3 buildings in the garden, Annex Standard Pool Rooms are 26 m ² . Rooms on the lower floors have direct access to the pool. Annex Standard Pool Rooms include twin or French beds, bathroom, minibar, TV, satellite and music channels, Wi-Fi connection, direct telephone, central air conditioning, safe, shower, hair dryer, tea and coffee set-up, carpeted floor and balcony. | 2+1 |
| Anex Family Room | Garden 39 m ² | Located next to the ocean pool and children's pool, Annex Family Rooms consist of two-storey annex buildings in the garden. They include a balcony, minibar, TV, satellite and music channels, Wi-Fi, direct telephone, central air conditioning, safe, shower, hair dryer, parquet floor and balcony. Lower floor family rooms: Consist of 1 large bathroom, 1 master bedroom and a second interconnected room with bunk beds and TV. Upper floor family rooms: Consist of 1 large bathroom, 1 master bedroom and a second interconnected room with beds for two children, a TV and tea and coffee set-up. | 3+1 |
| Duplex Suite | Main Building 65 m ² | Located in the main building, duplex rooms have 2 twin beds and 1 French bed. There is also a sitting area, bathroom, minibar, TV, satellite and music channels, Wi-Fi, direct telephone, central air conditioning, safe, hair dryer, capsule coffee machine and tea set-up, carpeted floor and balcony. | 3+1 |
| Junior Suite | Main Building 65 - 85 m ² | Located in the main building, Junior Suites are 65 - 85 m ² and include a French bed, seating area, minibar, LCD TV, satellite and music channels, Wi-Fi direct telephone, central air conditioning, safe, shower, hair dryer, capsule coffee machine and tea set-up, carpeted floor and balcony. | 3+1 |
| Accessible Room | Main Building 30 m ² | Located in the main building, Accessible Rooms are 30 m ² and include a French bed, balcony, bedroom, sitting area, bathroom, minibar, TV, satellite and music channels, Wi-Fi, direct telephone, central air conditioning and safe. There is a shower in the bathroom, and a hair dryer, tea and coffee set-up and carpeted floor. (Located one on each floor, the rooms offer easy access to all hotel areas by elevator and are designed to meet the needs of guests with physical disabilities. The room entrance, balcony and bathroom are designed for wheelchair access.) | 2+1 |
| Colonel Suite | Main Building 120 m ² | Located in the main building, Colonel Suites are 120 m ² and include a balcony, minibar, LCD TV, satellite and music channels, Wi-Fi, direct telephone, central air conditioning, safe, shower, hair dryer, capsule coffee machine, tea set-up and carpeted floor. Colonel Suites have a sea view and include a living room, master bedroom with king size bed, children's room with a twin bed, 1 parent's bathroom/bathroom with jacuzzi, 2 WCs, 1 bathroom with a shower, and a balcony. | 5+1 |
| Admiral Suite | Main Building 80 - 150 m ² | Located in the main building, the Admiral Suites are 80 -150 m ² . One has 2 rooms and the other has 3. They can be used as a single suite or separate rooms. The Admiral Suites include king size and twin beds, mini bar, LCD TV, satellite and music channels, internet connection, direct telephone, central air conditioning, safe, capsule coffee machine, tea set-up, bathroom with shower and bathtub, hair dryer, jacuzzi, parquet floor and terrace. | 5+1 |



FOOD AND DRINK

DELUXE ALL INCLUSIVE FOOD AND DRINKS GENERAL INFORMATION

| | | | | |
|---|--|---|--|--|
| Excellent hygiene standards across all services | Products made daily from fresh produce in all outlets | Quality brands, local and imported goods | 24-hour bar and restaurant | Snack restaurants with diverse menus |
| Complimentary snacks served with alcoholic drinks | Complimentary cookies served with hot drinks in the Lobby and Lounge | Wide variety of refreshments | Diverse night buffet | Complimentary Carte D'Or ice cream and waffles at specific times |
| Wide selection of minibar contents | Surprise treats for regular guests and Club members | Complimentary Birthday and Honeymoon treats | Special drinks service to sunbeds using QR codes at pool and beach | Special meal service for children on request |

MAIN RESTAURANT

| | | | |
|---|--|---|--|
| Welcome on arrival | Large, spacious indoor/outdoor sitting areas | Wide-ranging, high quality open buffet service with hygiene precautions | Freshly squeezed orange juice served at breakfast |
| Hot and cold drinks service to the table at breakfast | Luxury wine varieties from specific brands | Fresh bakery products service at all meals | Oven-fresh Turkish pizza selection at midday and evening times |
| Freshly made hot and cold food service at all meals | Grilled meat, fish and chicken varieties at all meals | Fresh cheese and deli meat buffet at all meals | Buffet with diverse selection of diet options at all meals |
| Buffet with diverse selection of seafoods | 'Special Presentation of The Chef' buffet with evening performance | Luxury local and imported alcoholic and non-alcoholic drinks | Variety of dishes from global cuisine |
| Vegan Buffet | | | |

SNACK RESTAURANTS

| | | | |
|---|---|---------------------------|---|
| Welcome at the door, table service | Snack menus with wide choice of options | Saporo Italian Snack menu | Turkish Pizza, Gözleme, Pastries, Pita Pan Restaurant |
| Doner, Hamburger, Spit Roast Chicken varieties, Beach Stella Snack Restaurant | Quality local and imported alcoholic and non-alcoholic drinks | Evening à la carte snacks | Tini Kids Club Snack Restaurant |

PATISSERIE

| | | | |
|---------------------------------------|---|---------------------------------------|--|
| Wide selection of patisserie products | Freshly baked products made from superior ingredients | Self-service or table service options | Top quality, branded hot and cold non-alcoholic drinks |
|---------------------------------------|---|---------------------------------------|--|

A'LA CARTE RESTAURANTS

| | | | |
|---|---|---|---|
| Reservation required | A cover charge is applied | Welcome on arrival and escorted to table | Themed atmosphere and decoration |
| Choice of à la carte dining or set menu | Unlimited luxury alcoholic and non-alcoholic drinks | Extensive wine menu and sommelier service | Wines and alcoholic drinks outside of the concept are charged for |



FOOD AND DRINK OUTLETS SERVICE HOURS

FOOD OUTLETS

SUMMER SEASON

| Restaurant | Section | Service | Details | Opening - Closing | All inclusive |
|------------------------------|------------------------|--------------|---|---|--|
| Parkfora | Main Restaurant | Open buffet | Serves a wide selection of delicious world cuisines. | 08:00 – 11:00 12:30 – 14:30 19:00 – 21:30 | X |
| Children's Buffet | Main Restaurant | Open buffet | Baby Foods microwave + mixer service | 08:00 – 10:30 12:30 – 13:30 18:30 – 19:30 | X |
| Beef Grill Club | Steak House | À la carte | Serves steak and dry aged meat options. | 19:00 – 22:00 | Charged (€45) (0-3 years Free / 4-6 years €25) |
| Pascarella | Italian Restaurant | À la carte | Serves a wide variety of delicious Italian dishes. | 19:00 – 22:00 | Charged (€25) (0-5 years Free / 6-12 years €15) |
| Çapari | Fish Restaurant | À la carte | Serves daily fresh seafoods from the special display cabinet | 19:00 – 22:00 | Charged (€25) (0-5 years Free / 6-12 years €15) |
| Nori | Japanese | À la carte | Serves a selection of Asian cuisines. | 19:00 – 22:00 | Charged (€25) (0-5 years Free / 6-12 years €15) |
| The Pier Tavern (Wednesdays) | BBQ Restaurant | À la carte | Serves traditional Turkish foods and grills on the pier. | 20:00 – 23:00 | Charged (€40) (0-3 years Free / 4-6 years €20) |
| Stella Snack | Stella | À la carte | Pastries, Turkish Pizza & Snack foods | 12:00 – 16:00 | X |
| Sapore Italian Snacks | Stella | À la carte | Italian menu | 11:00 – 18:00 | X |
| Tini Kids Club Snack | Tini Kids Club | À la carte | Fast Food & Snacks | 12:00 – 15:30 18:30 – 20:30 | X |
| Night A la 'Carte Snacks | Night Snack Restaurant | À la carte | Various fast foods | 23:00 – 08:00 | X |
| Patisserie | Cordelia Patisserie | Self Service | Hot and cold pastries, sweet and savoury baked goods, various cakes and desserts | 18:30 – 23:00 | X |
| Solaris Patisserie | Solaris Bar | Self Service | Hot and cold pastries, sweet and savoury baked goods, various cakes and desserts, fruit selection | 12:00 – 18:30 | X |
| Solaris Patisserie | Solaris Bar | Self Service | Ice cream varieties | 10:00 – 23:00 | X |
| Solaris Patisserie | Solaris Bar | Self Service | Waffles, Baked Potatoes | 12:00 – 18:30 16:00 – 18:00 | X |
| Beach Patisserie | Beach Bar | Self Service | Hot and cold cakes, sweet and savoury baked goods, dessert selection, | 12:00 – 18:00 | X |
| Beach Patisserie | Beach Bar | Self Service | Fruit, Ice Cream and Waffles | 12:00 – 18:00 | X |
| Room Service | Room Service | Room Service | Selected food and drinks from the menu | 24 hours | Charged |

WINTER SEASON (2023-2024)

| Restaurant | Section | Service | Details | Opening - Closing | All inclusive |
|---------------------|------------------------|---------------|--|---|---|
| Parkfora | Main Restaurant | Open buffet | Serves a wide selection of delicious world cuisines. | 08:00 - 10:30 12:30 - 14:30 18:30 - 21:00 | X |
| Children's Buffet | Main Restaurant | Open buffet | Baby Foods microwave + mixer service | 08:00 - 10:30 12:30 - 13:30 18:30 - 19:30 | X |
| Beef Grill Club | Steak House | À la carte | Serves steak and dry aged meat options. | 19:00 - 22:00 | Charged (€39) (0-3 years free / 4-6 years €20) |
| Pascarella | Italian Restaurant | À la carte | Serves a wide variety of delicious Italian dishes. | 18:30 - 22:00 | Charged (€25) (0-5 years free / 6-12 years €15) |
| Çapari | Fish Restaurant | À la carte | Serves daily fresh seafoods from the special display cabinet | 18:30 - 22:00 | Charged (€25) (0-5 years free / 6-12 years €15) |
| Nori | Japanese | À la carte | Serves a selection of Asian cuisines. | 18:30 - 22:00 | Charged (€25) (0-5 years free / 6-12 years €15) |
| Tavern Night | BBQ Restaurant | À la carte | Traditional Turkish dishes and grills | 19:00 - 22:00 | Charged (€35) (0-3 years free / 4-6 years €17.5) |
| Ala Carte Snacks | Italian Restaurant | À la carte | Fast Food & Snacks | 14:30-18:00 | X |
| Snacks | Night Snack Restaurant | À la carte | Various fast foods | 23:00 - 24:00 | X |
| Cordelia patisserie | Patisserie | Table service | Hot and cold pastries, sweet and savoury baked goods, various desserts | 12:00 - 23:00 | X |
| Room Service | Menu | Room Service | Selected food and drinks from the menu | 24 hours | Charged |

BARS SUMMER SEASON

| Bar | Opening - Closing |
|-----------------------------------|-------------------|
| Cordelia - Lobby Bar | 09:00 - 24:00 |
| Armonia - Pool Bar | 10:00 - 24:00 |
| Schiller Coffee Corner - Pool Bar | 08:00 - 12:00 |
| Solaris - Pool Bar | 10:00 - 24:00 |
| Aqua Bar - Pool Bar | 10:00 - 18:00 |
| Beach Bar - Beach Bar | 10:00 - 18:00 |
| Ocean Bar - Beach Bar | 10:00 - 18:00 |
| Vitamin - Indoor Pool Bar | 10:00 - 19:00 |
| Caprice - Lobby Bar | Closed |
| Ocean Disco Bar-Beach | 23:00 - 01:00 |
| Bowling Bar | Open 24 hours |
| Caprice - Patisserie | 18:30 - 23:00 |

WINTER SEASON

| Bar | Opening - Closing |
|--|--|
| Cordelia - Lobby Bar | 10:00 - 24:00 |
| Armonia - Pool Bar | (Closed) |
| Solaris - Pool Bar | (Closed) |
| Ocean Beach Bar (Tea - Coffee Machine) | 10:00 - 16:00 (Depending on the weather) |
| Vitamin - Indoor Pool Bar | 10:00 - 19:00 |
| Caprice - Lobby Bar | 10:00 - 24:00 |
| Bowling Bar | Open 24 hours |
| Patisserie | 14:30 - 23:00 |

DELUXE ALL INCLUSIVE DRINKS CONCEPT SUMMER SEASON

| | | | | | | |
|----------|---|--------------------------------|---------------------------------|--|---------------------|----------|
| Whiskies | Chivas Regal 12 YO Chivas Regal 18YO (SadeceLobbyBar) | Jack Daniel's Jameson | J. Walker Red Label J&B Rare | J.Walker Black Label Glenlivet 12 Y.O | Ballantine's | Jim beam |
| Vodkas | Absolut | Smirnoff | Gilbey's | Finlandia | | |
| Gins | Beefeater | Gordon's | Gilbey's | Bombay Sapphire | Hendrick's | |
| Rums | Havana Club 3 | Captain Morgan | Havana Club 7 | | | |
| Tequilas | Olmecca Blanco | Olmecca Gold | Muadil Tekila | | | |
| Cognac | Kanyak vs | Martel vs | Kanyak vsop | | | |
| Raki | Yeni Raki | Tekirdağ Raki Tekirdağ Gold | Efe Gold Raki Efe Yaş üzüm | Beylerbeyi Göbek | Yeni Raki yeni seri | |
| Starters | Vermouth Bianco Rosso Extra Dry | GarroneBitter | Fernet Branca | Campari | Jagermeister | |
| Beers | Efes Pilsen | Miller | Heineken | Beck's | Corona | |
| Liquors | Kahlua | Malibu | Safari Drambuie | Bailey's Irish cream | Archer's | Sambuca |

WINTER SEASON

| | | | | |
|----------|------------------------------------|--------------------------------|-----------------|---------------|
| Whiskies | *Chivas Regal 12 YO | J&B Rare | Ballantine's | Jack Daniels |
| Vodkas | Absolut | Gilbey's | Smirnoff | |
| Gins | Gilbey's | Beefeater | Gordon's | |
| Rums | Havana Club | Captain Morgan | | |
| Tequilas | Olmecca Blanco | Olmecca Gold | Acapulco Silver | San luis |
| Cognac | Konyak VSOP | Brandy Sorau | | |
| Raki | Efe Gold Raki | Efe Yaş üzüm Raki | Yeni Raki | Tekirdağ Gold |
| Starters | Vermouth Bianco Rosso Extra Dry | Garrone Bitter - Fernet Branca | Jager Meister | Aperitivo |
| Beers | Efes Pilsen Draft | Miller | Beck's | |
| Liquors | Irish cream - Malibu | Safari Sambuca | Tia Maria | Kahlua |



BEACH AND POOLS (SUMMER CONCEPT)

| | | | | |
|---|---|--|------------------------------|-------------------|
| 350 Meters Beach Seaside | Sunbeds and Parasols | Special Sun Decks | VIP Cabana Service (charged) | Lifeguard Service |
| Towels and Sunbeds are available at all beaches and pools | Drinks can be ordered at beaches and pools from sunbeds with QR code system | Beach Snack Restaurants, Patisserie and Bars | | |

POOLS

Indoor and outdoor pools of different sizes with a variety of equipment

| Pool | Outdoor | Indoor | Heated | Depth | Area m ² |
|---|---------|--------|--------|--------|---------------------|
| Indoor Pool (Winter concept) | | X | X | 140 cm | 170 m ² |
| Indoor Children's Pool (Winter concept) | | X | X | 30 cm | 20 m ² |
| Outdoor Main Pool | X | | | 140 cm | 4500 m ² |
| Olympic swimming pool | X | | | 180 cm | 1250 m ² |
| Semi-Olympic Pool | X | | | 140 cm | 315 m ² |
| Aquapark Pool | X | | | 105 cm | 180 m ² |
| Kids Slides Pool* | X | | | 30 cm | 750 m ² |

*Aquapark can be used by children over the age of 6. Opening hours 10:00-12:30 & 14:30-17:00
Towel Desk 08:00 – 19:00

ADULT SLIDES

| | |
|-------------------------|----------------------|
| 1 Black Hole 63 M | 1 Rafting Slide 69 M |
| 1 Turbulence Slide 72 M | 1 Aquatube 62 M |

CHILDREN'S SLIDES

| | |
|-------------------|------------------------|
| 1 Aqua Tower | 1 Octopus Slide |
| 1 Snake Slide | 1 Wide Slide |
| 1 Kids Body Slide | 1 Kids Tunnel Freefall |



BEFINE SPA

| | | | |
|---------|-----------------------------|--------------------|--------------|
| Free | Fitness Center | Turkish Bath | 1 steam room |
| | 2 saunas | Snow room | Jacuzzi |
| | Resting room | Indoor pool | Outdoor pool |
| Charged | Massage and Hammam Services | Skin and Body Care | |



TINI KIDS CLUB

Tini Kids Club has been completely redesigned for kids of all ages. Our multilingual teachers have excellent communication skills, offering children well-planned activities and endless fun.

| Facilities |
|--|
| Kids Club for age group 4 – 7.99 (under 4s can attend with parents) |
| Junior Club for age group 8 – 11.99 – Teenage Club for age group 12 – 16.99 |
| Special shows for children |
| Outdoor and indoor children's play areas |
| Birthday parties |
| Private birthday parties (charged) |
| TINI Kids Snack Restaurant (special Children's Snack Menu (Fast food, Ice Cream, Fruit and Dessert Selection)) |
| Tini Kids Snack Restaurant Opening and Closing Times 12:00 15:30 // 18:30 20:30 |

*Tini Kids Club service hours and venues vary according to the season.
Working hours in the summer season are between 09:00 and 24:00.



ENTERTAINMENT & ACTIVITY

DAYTIME ACTIVITIES

| | | | |
|--|---------------------|-------------------------------|------------------------|
| Morning Gymnastics and Aqua Gymnastics | Step & Aerobics | Boccia | Cinema |
| Latin and Belly Dance courses | Basketball | Coffee, Cards and Board Games | Football (Grass Field) |
| Beach Volleyball | Swimming Pool Games | Water Polo | Shooting |
| Bowling | Amusement Machines | Billiards | |

EVENING ACTIVITIES

| | | | |
|--|---------------------------|-----------------|---------|
| World-famous international performance groups and acrobatic displays | Live music with orchestra | Concept Parties | Karaoke |
| Ocean Disco | | | |

WATER SPORTS

| | | | | |
|----------------|--------------------------------|--------------------------|------------------------|-------------------------------------|
| Free | Windsurfing (Requires License) | | | |
| Charged | Diving Lessons | Water Skiing | Jet Skis | Canoeing and Pedalos (on the river) |
| | Parasailing | Private Swimming Lessons | Motorised Water Sports | |

FITNESS CENTRE

| | | |
|---------------------|---|---|
| Sports Areas | Sports complex outside the hotel containing 4 professional-size turf football pitches (2 pitches 68 m x 105 m, 2 pitches 60 m x 90 m, parking area, 500-person tribune people, 4 changing rooms, 2 referee rooms, 1 doctor's room, 1 doping room) | Mini turf football field inside the hotel |
| | 4 tartan surface tennis courts | 1 multi-purpose field |
| | Olympic Pool (50 m x 25 m x 1.80 m, 10 lanes and diving boards, backlighting, special chronometer) | 1 stretching area is available to gym groups. |
| | Use of the mini football field, basketball and tennis courts is offered free of charge to hotel guests. | |

MEETING FACILITIES

There is 1 large conference hall (1173 m²) that can be divided into 3 sections, along with 12 meeting rooms of different sizes. The rooms are equipped with the latest technology and are suitable for a variety of groups and organisations.

ATLANTIC HALLS

Atlantic 



| Halls | Area (m ²) | Width (m) | Length (m) | Ceiling Height (m) | Banquet | Theater | Classroom | Cocktail |
|-------------------------|------------------------|-----------|------------|--------------------|---------|---------|-----------|----------|
| Atlantic I (Daylight) | 90 | 7.4 | 12,2 | 2.6 | - | 80 | 50 | - |
| Atlantic II (Daylight) | 90 | 7.4 | 12,2 | 2.6 | - | 80 | 50 | - |
| Atlantic III (Daylight) | 90 | 7.4 | 12, | 2.6 | - | 80 | 50 | - |
| Atlantic IV (Daylight) | 111 | 7.2 | 15,4 | 2.6 | - | 100 | 70 | - |

PACIFIC HALLS

Pacific 

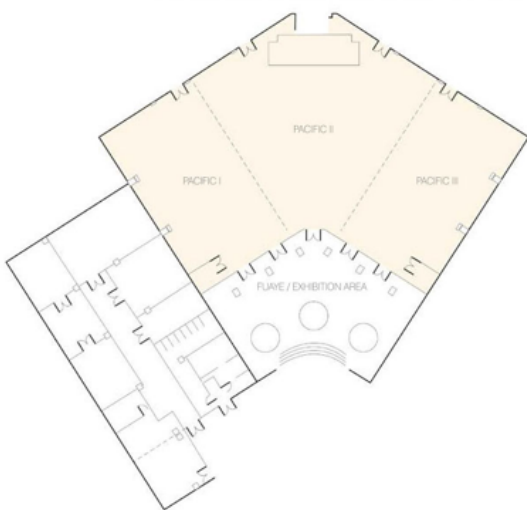

| Halls | Area (m ²) | Width (m) | Length (m) | Ceiling Height (m) | Banquet | Theater | Classroom | Cocktail |
|-------------|------------------------|-----------|------------|--------------------|---------|---------|-----------|----------|
| Pacific | 1152 | 24 | 48 | 5.5 | 1000 | 1500 | 600 | 1500 |
| Foyer | 340 | - | - | 5 | - | - | - | 300 |
| Pacific I | 336 | 14 | 24 | 4.5 | 150 | 300 | 150 | 250 |
| Pacific II | 500 | 20 | 25 | 4.5 | 300 | 500 | 250 | 400 |
| Pacific III | 336 | 14 | 24 | 4.5 | 150 | 300 | 150 | 250 |

BLACK SEA HALLS

Black Sea

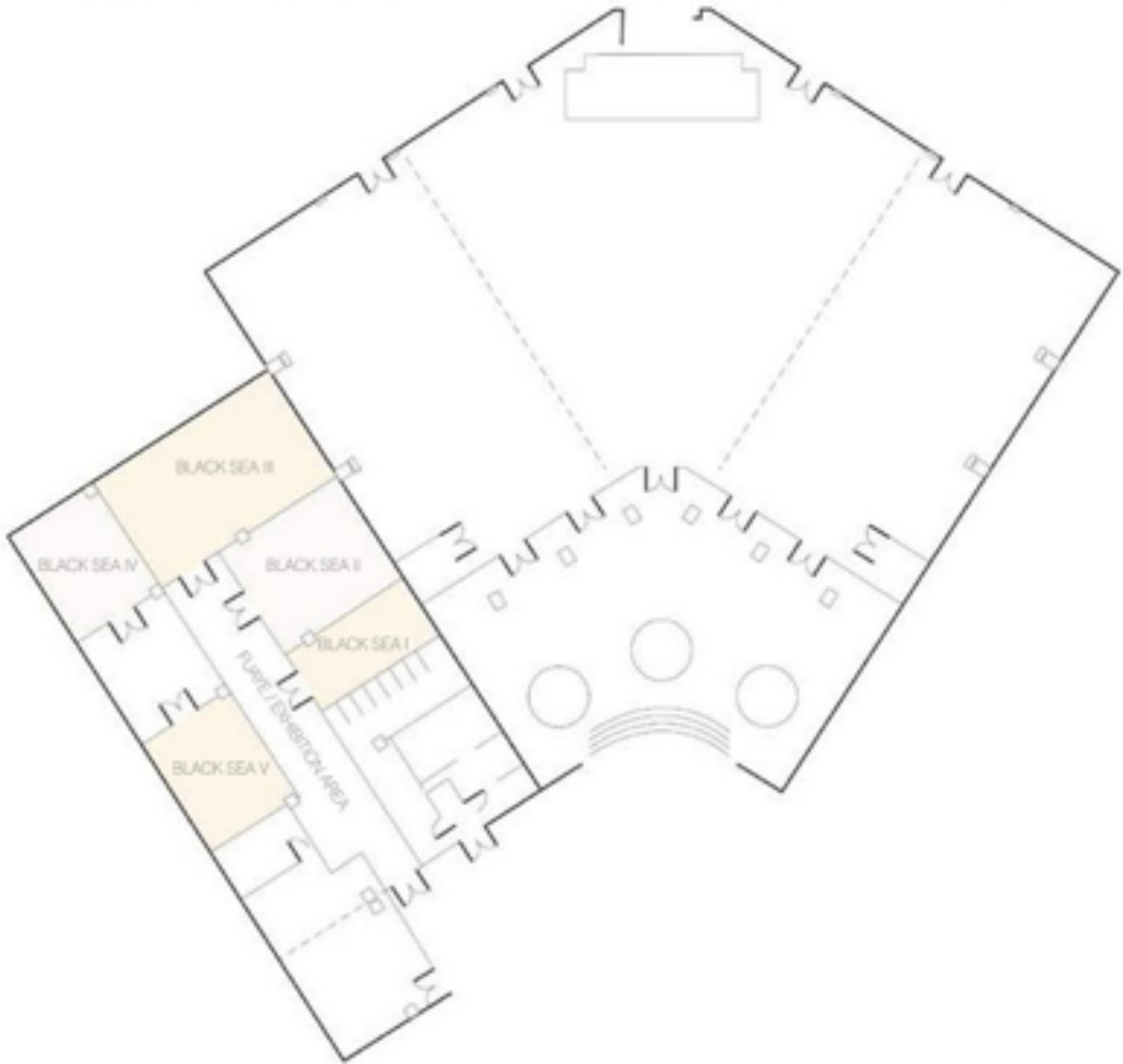

| Halls | Area (m ²) | Width (m) | Length (m) | Ceiling Height (m) | Banquet | Theater | Classroom | Cocktail |
|---------------|------------------------|-----------|------------|--------------------|---------|---------|-----------|----------|
| Black Sea I | 30 | 3,9 | 7,8 | 4,4 | - | 20 | 12 | - |
| Black Sea II | 58 | 7,4 | 7,9 | 4,4 | - | 50 | 30 | - |
| Black Sea III | 88 | 7,4 | 12 | 4,4 | - | 90 | 60 | - |
| Black Sea IV | 44 | 7,4 | 6 | 2,6 | - | 40 | 20 | - |
| Black Sea V | 44 | 7,4 | 6 | 2,6 | - | 40 | 20 | - |



CULLINAN LINKS GOLF CLUB

Cullinan Links Golf Club has the distinction of being the only golf course in Turkey that borders a river and the sea.

Cullinan Links Golf Club has been updated to a 36-hole course by “European Golf Design”, the world’s leading golf course design firm.

With its illuminated driving range, the Cullinan Links Golf Club offers golf lovers the pleasure of playing with a golf cart throughout all 4 seasons, as well as lessons at the Golf Academy from internationally certified golf instructors.

| | |
|-----------------------------|---|
| Official Opening | October 11, 2021 |
| Range Area | 1,100,000 m ² (110 hectares) |
| Opening Times | Summer: 07:00 – 19:00 Winter: 08:00 – 18:00 F&B ALL INCLUSIVE CONCEPT |
| Usual Wind Direction | North (Taurus Mountains) in the morning, South (Seaside) in the afternoon |
| Turf Type | Summer: Paspalum Winter: Poa and Lolium perenne |
| Measurements | Fairway markers are measured starting from the Green. Green size is 600m ² on average. |
| Tee Size | Average 250 m ² (White-Yellow-Red) |
| Bunker | Total 119 - Fairway Bunker 42 |
| Green Bunker | 77 |
| Lakes | 10 in total |
| River | Beşgöz Stream |
| Driving Range | 40 turf tees (105 m), 20 sheltered tees (105 m) 36.000 m ² |
| Putting Green | Total 5: 1 x 1042 m ² (18 holes), 4 x average 500 m ² (9 holes) |
| Pitching Green | 2 Chipping Greens – 735 m ² and 432 m ² |
| Golf Carts | 64 |
| Trolleys | 240 |
| Golf Bags for Rent | Left and right hand |
| Golf Lessons | Lessons at all levels are taught by PGA professionals. |
| Max HCP. | Men 36 HCP, Women 44 HCP |

OUR SUSTAINABILITY JOURNEY

The Titanic Deluxe Lara was one of the first hotels to be accredited by the Global Sustainable Tourism Council (GSTC).

The Titanic Deluxe Lara has implemented a sustainability management system in compliance with the criteria of the GSTC Global Sustainable Tourism Council, with particular emphasis on continuous protection of the environment and natural world, respect for human rights - including social and cultural values, standing against child exploitation, protecting the rights of vulnerable groups and cooperating with local communities.

By acting responsibly in all areas necessary for delivering sustainable tourism, we try to augment the customer experience, increase awareness among staff, guests and suppliers, increase efficiency, reduce expenses, and enhance the ecosystem and human well-being. Our hotel investment plans are aimed at maintaining the optimum standards for ensuring the continuous reduction of environmental impact and encouraging sustainable development and growth.

We ask our valued guests to stand by us and give us their support on this journey.



BERLIN

TITANIC

HOTELS

ISTANBUL

BODRUM

ANTALYA

TITANIC HOTELS

ANTALYA | ISTANBUL | BODRUM | BERLIN

titanic.com.tr

#MyTitanicStory

