

## complimentary breakout catering at coast edmonton plaza hotel by apa

### planning a full-day meeting or conference?

Book both breakfast and lunch catering with us and enjoy a complimentary breakout catering package – the perfect way to keep your guests energized and engaged throughout the day.

### what's included:

- A delicious breakfast and lunch buffet (minimum of 10 guests)
- A complimentary breakout session, featuring:
  - Two snack items of your choice
  - Freshly brewed coffee and a selection of teas
  - All items selected from our existing catering menu

Whether it's a mid-morning recharge or an afternoon pick-me-up, our breakout catering is designed to satisfy and refresh your attendees.

### Terms & conditions

\* Offer does not include applicable taxes, fees or gratuities

\* Buffet menu service is available for groups of 10 or more guests. A minimum of 10 confirmed attendees is required to qualify.

\* Room rental discount applicable when at least one catering order (breakfast, lunch, or dinner) is ordered for the function.

**Learn more: Meeting Planner  
Rewards Points Program**

**Learn more:  
Meeting and Events Planning**



**contact our sales team today at 780.423.7529 or visit**  
[www.coasthotels.com/coast-edmonton-plaza-hotel-by-apa/](http://www.coasthotels.com/coast-edmonton-plaza-hotel-by-apa/)

**Make Your Next Event Extra Rewarding!**

**coast rewards™**

**AEROPLAN**



**Alaska  
Mileage Plan**

*the perfect venue for your meetings, events and celebrations*

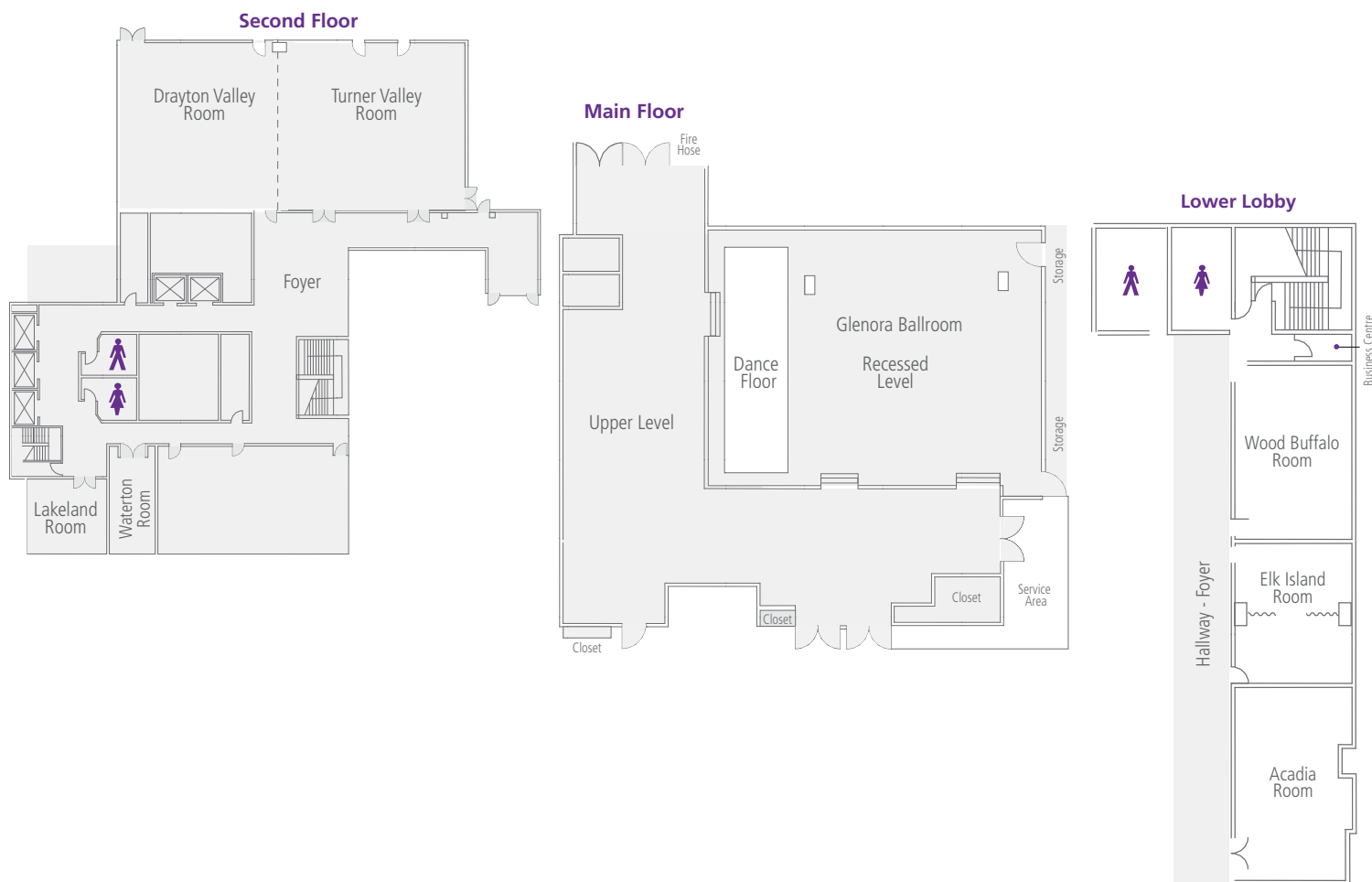

## Room Specifications

Meeting Room	Theatre	Classroom	Boardroom	Dinner	Dinner/Dance	Reception	U-Shape	Hollow Sq.	Sq.Ft.	Dimensions	Location
ACADIA ROOM	70	40	40	50	30	75	30	35	756	36'x21'	Lower floor
ELK ISLAND ROOM	46	30	24	40	30	40	26	30	546	26'x21'	Lower floor
WOOD BUFFALO ROOM	50	40	30	50	30	65	30	35	672	32'x21'	Lower floor
VALLEY BALLROOM	500	300	N/A	350	250	450	N/A	N/A	4365	97' x 45'	2nd flr.
DRAYTON VALLEY	250	120	60	140	130	220	60	80	2304	48' x 48'	2nd flr.
TURNER VALLEY	250	120	60	140	N/A	220	70	80	2496	48' x 52'	2nd flr.
LAKELAND ROOM	40	16	19	32	N/A	40	N/A	N/A	460	23' x 20'	2nd flr.
WATERTON ROOM	N/A	N/A	12	12	N/A	N/A	N/A	N/A	364	13' x 28'	2nd flr.
GLENORA BALLROOM	160	40	50	100	100	200	40	40	3328	52' 64'	Main flr.
PVB LOUNGE	30	16	20	30	N/A	90	20	N/A	748	44' x 17'	22nd flr.

contact our sales team today at 780.423.7529 or visit  
[www.coasthotels.com/coast-edmonton-plaza-hotel-by-apa/](http://www.coasthotels.com/coast-edmonton-plaza-hotel-by-apa/)

Make Your Next Event Extra Rewarding!

coast rewards™

AEROPLAN

Alaska  
Mileage Plan