

MÖBELLAYOUT SEASIDE 3 PLAN 0

MONTECINOS FRANJOLA DESIGN

FÖRENINGSGATAN 34
41127 GÖTEBORG

RIVERTON
STORA BADHUSGATAN 26

SEAL



THIS DRAWING IS FOR INFORMATION ONLY AND TO BE USED AS A GENERAL ARRANGEMENT OF INTERIOR CONDITIONS. IT HAS BEEN CREATED FROM AVAILABLE INFORMATION. ALL MEASUREMENTS MUST BE VERIFIED BY THE CONTRACTOR BEFORE FINAL DETAILING AND FABRICATION. THIS DRAWING MUST BE APPROVED BY THE PROJECT ARCHITECT AND/OR ENGINEER TO ENSURE COMPLIANCE WITH ALL APPLICABLE REGULATIONS. THIS DRAWING IS EXCLUSIVE PROPERTY OF MONTECINOS FRANJOLA DESIGN AND CONTAINS CONFIDENTIAL SUBJECT MATTER. ALL RIGHTS, INCLUDING COPYRIGHTS OF THE DRAWING ARE RESERVED BY MONTECINOS FRANJOLA DESIGN. THIS DRAWING IS ISSUED ON THE CONDITION THAT IT IS NOT DUPLICATED OR DISCLOSED TO ANY THIRD PARTY, EITHER WHOLLY OR IN PART WITHOUT WRITTEN CONSENT OF MONTECINOS FRANJOLA DESIGN.

REVISIONS / ISSUED:



STATUS:

—

PROJECT:

RIVERTON

DRAWN BY:

MMF/GKC

SET DATE:

08/10/2018

DATE:

28/08/2019

SCALE:

1:100

SHEET NUMBER:

LAYOUT

RIVERTON PLAN 0
MÖBELLAYOUT
SEASIDE 3

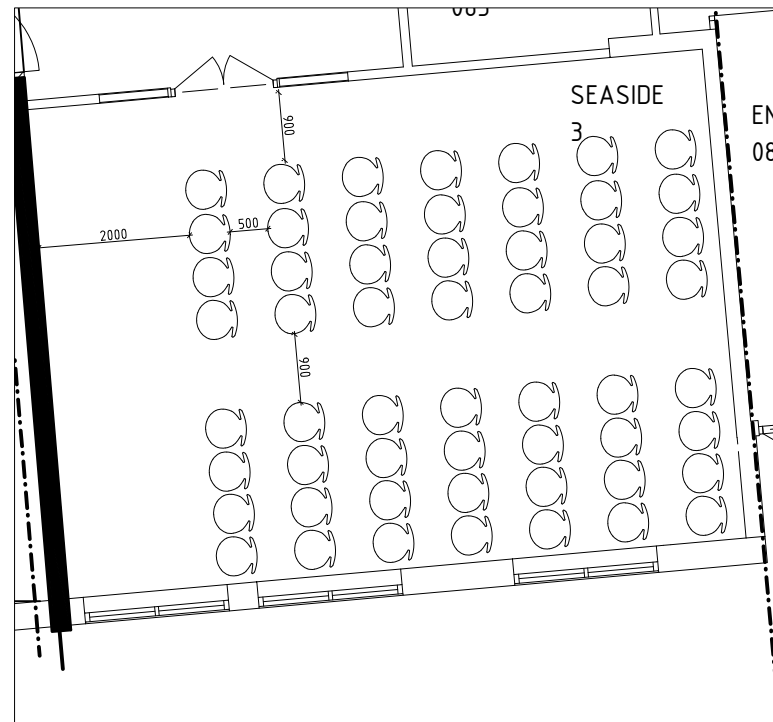

1 MÖBEL-LAYOUT 1
SCALE: 1:100

ANTAL PLATSER: 56 PLATSER

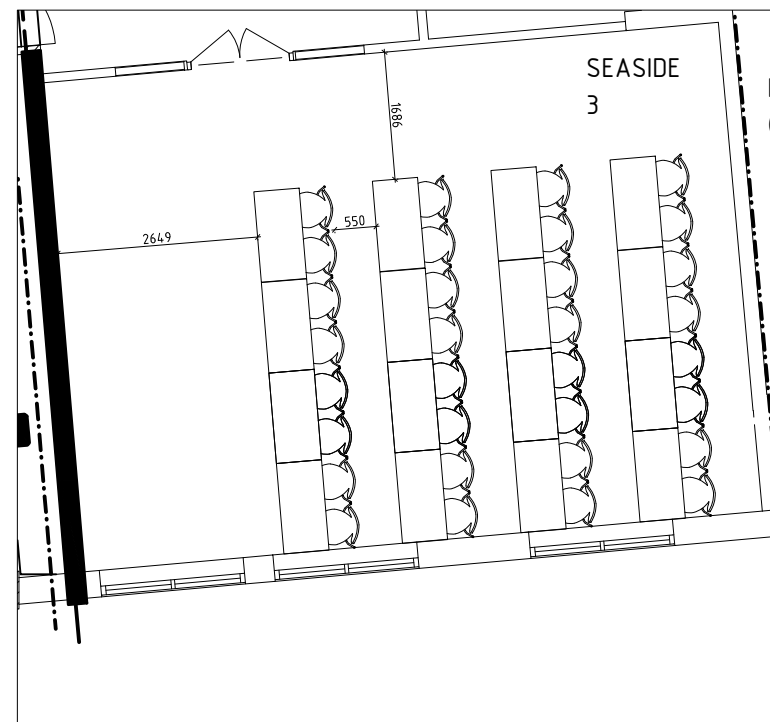

2 MÖBEL-LAYOUT 2
SCALE: 1:100

ANTAL PLATSER: 32 PLATSER

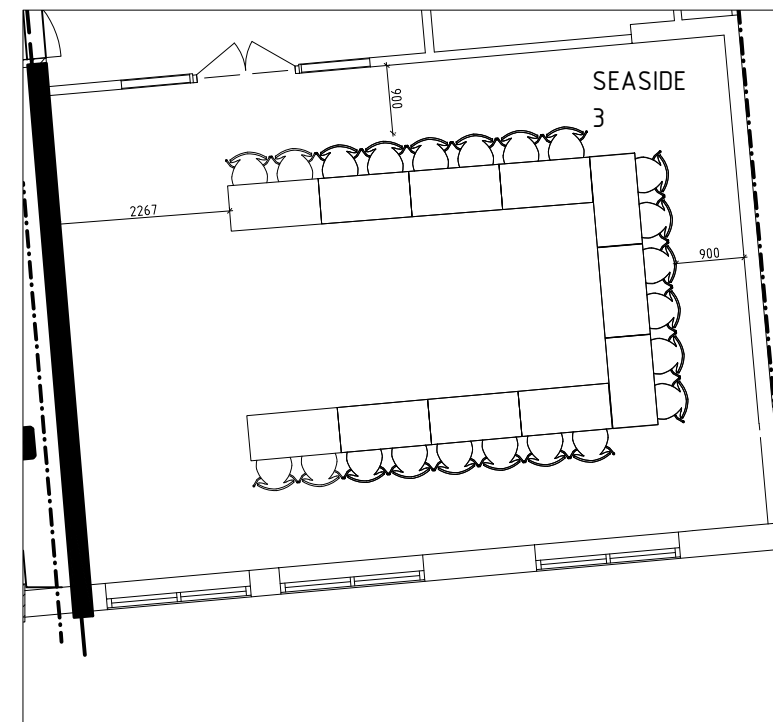

3 MÖBEL-LAYOUT 3
SCALE: 1:100

ANTAL PLATSER: 22 PLATSER

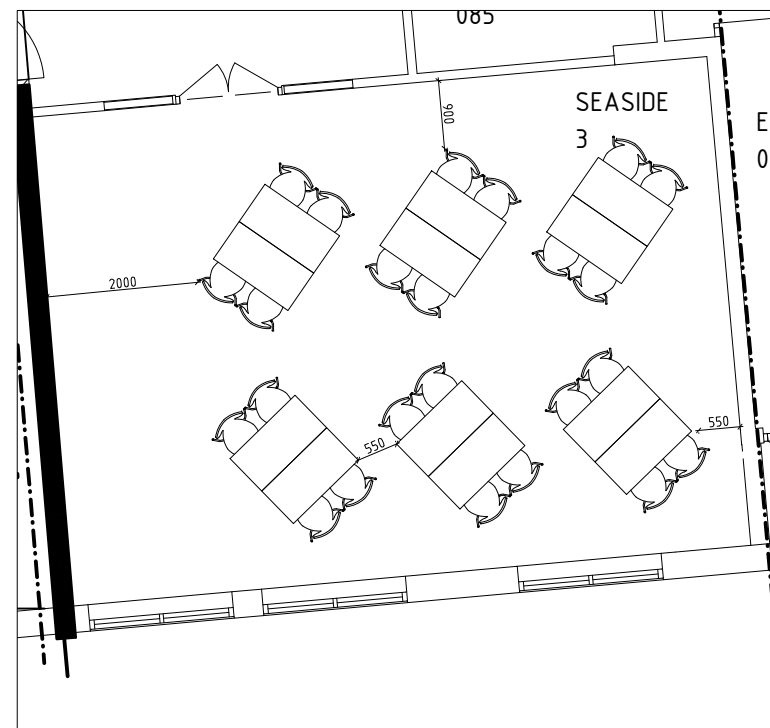

4 MÖBEL-LAYOUT 4
SCALE: 1:100

ANTAL PLATSER: 24 PLATSER

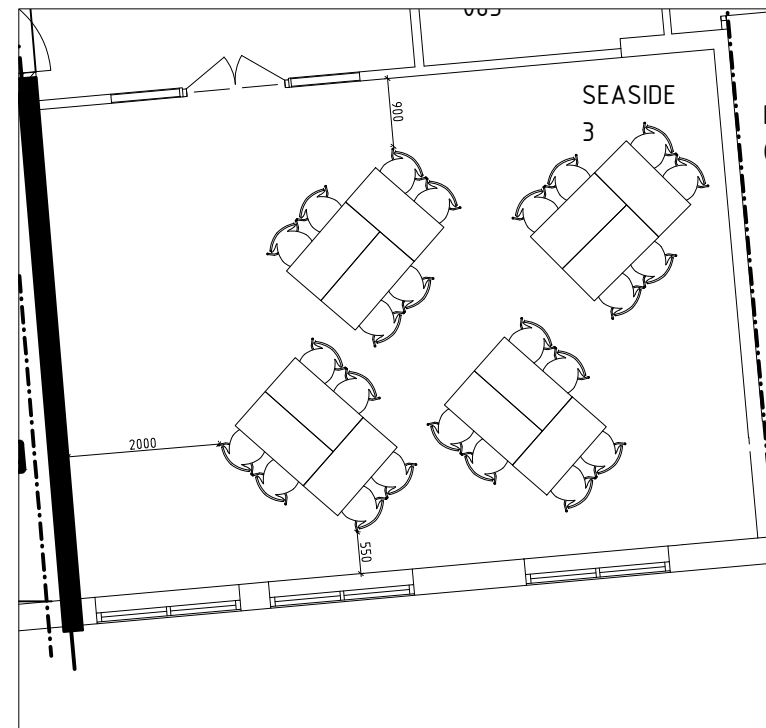

5 MÖBEL-LAYOUT 5
SCALE: 1:100

ANTAL PLATSER: 24 PLATSER