



small meetings made simple

Flexible, Inclusive, and Designed for Success

Whether you're hosting an intimate strategy session or a team planning meeting, our **Small Meetings Packages** make it easy to focus on what matters most — your people and your goals.

FOR 10-25 GUESTS | \$80 PER PERSON

Package Includes:

- Complimentary meeting room
- Complimentary guest room stay for the organizer for the duration of the event
- Complimentary Wi-Fi
- Full Continental or European Continental Buffet
- Complimentary parking for the organizer
- Discounted parking for attendees
 - \$25 day parking
 - \$30 overnight parking

PACKAGE ENHANCEMENTS

- Add \$10 per person for a hot breakfast, lunch wraps, or sandwich boards
- Coffee breaks starting at \$15 per person
- 25% discount on audio visual equipment

Terms & Conditions

- * Book by April 2, 2026, for events that materialize by June 10, 2026
- * Subject to availability
- * Valid for a minimum of 10 attendees and maximum of 25 attendees
- * The number of attendees will determine the size of the meeting room
- * Rate is per person, per day and does not include applicable taxes and fees
- * Promotion applicable to new bookings only and cannot be combined with any other offers or discounts



coast coal harbour vancouver hotel by apa sales & catering
ccc.sales@coasthotels.com t. 604.697.0202

Make Your Next Event Extra Rewarding!

coast rewards™

ATMOS
REWARDS

AÉROPLAN 

the perfect venue for your meetings, events and celebrations

Third Floor - 3F

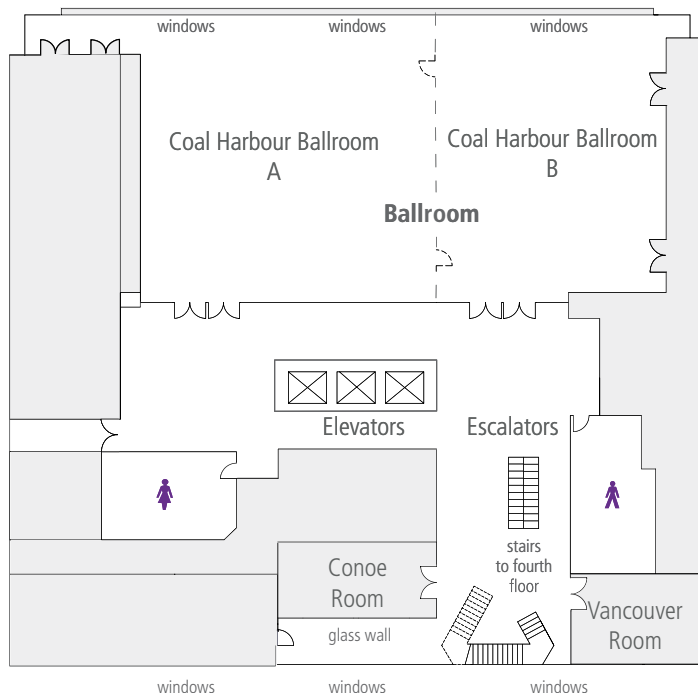

Fourth Floor - 4F

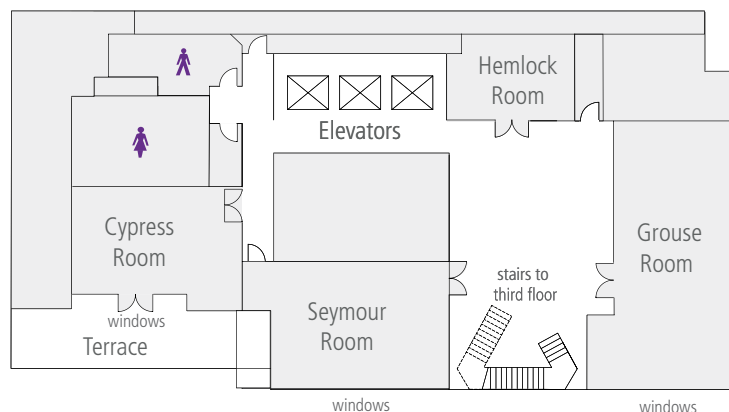

Room Specifications

Meeting Room	Theatre	Classroom 2 per table	Classroom 3 per table	Boardroom	Rounds of 6	Rounds of 8	Reception	U-Shape	Hollow Sq.	Ceiling Height
COAL HARBOUR BALLROOM	500	224	336	—	216	288	500	—	—	20'
COAL HARBOUR A	300	128	192	—	120	160	300	60	70	20'
COAL HARBOUR B	200	96	144	—	96	128	200	50	60	20'
CONOE	—	—	—	16	—	—	—	—	—	9'
VANCOUVER	25	12	15	14	12	16	15	—	—	10'
GROUSE	80	32	48	38	42	56	70	34	32	9'
SEYMOUR	40	24	36	20	24	32	50	20	22	8'6"
CYPRESS	24	14	21	16	18	16	30	16	18	9'
HEMLOCK	12	8	12	8	6	8	—	—	—	8'10"

Please note the capacity is the maximum for each space and does not account for AV set up, dance floors, DJ, photo booths, bars, and buffets. Wider aisles are required for wheelchair, staging, and ramp access.

Learn more: Refreshingly Unique Meetings and Events

Learn more: Meeting Planner Rewards Points Program