

elegant. relaxed. comfort.



WE MAKE MEETINGS EASY

DAY DELEGATE RATE

Dedicated Conference Host

Conference Room Hire

Paper Pads, Pens, Name Cards and Sweets

Toolbox of Essential Office Equipment

LCD Projector and Screen

Complimentary High Speed Internet

24 - HOUR RESIDENTIAL RATE

Includes all of the above, in addition to the following:

Overnight Accommodation

Full Scottish Breakfast

THE IDEAL SETTING FOR MEETINGS AND GROUP ACCOMMODATIONS

Elegant, sleek and modern, Sandman Signature Aberdeen Hotel is four-star hospitality at its best. Our hotel features three newly refurbished conference rooms available for hosting meetings, events and conferences of up to 400 delegates and flexible space for comfortable break-out areas.





Our experienced staff will meet your highest expectations with set-up and your bespoke specifications. Our dedicated Events Team will handle all your booking enquiries, look after your event and will be your on-site contact to ensure your event is a success.

For more information, please contact our Conference & Events Team at Tel: **01224 945 555**
Email: eventsales_aberdeen@sandmanhotels.co.uk

Room hire packages are available upon request.

Terms & Conditions: Packages include all service charges and VAT.
Special cancellation and deposit policies apply and may vary per contract.
Subject to availability. Some restrictions may apply.

MEETING & CONFERENCE FACILITIES ROOM CAPACITY CHART

		CAPACITY					
ROOM NAMES	Size in m ²	Classroom 	Theatre 	U Shape 	Board Room 	Banqueting 	Ceiling Height (metres)
Robert Gordon Ballroom	420	240	400	200	130	320	7
	Robert Gordon Ballroom can be split evenly into two separate spaces with equal seating on both sides						
Alberta	105	48	100	46	44	100	3.3
Fort McMurray	54.5	24	50	30	22	50	3.3
Edmonton	50.5	24	50	30	22	50	3.3
Maple	42	16	30	16	22	30	3.3

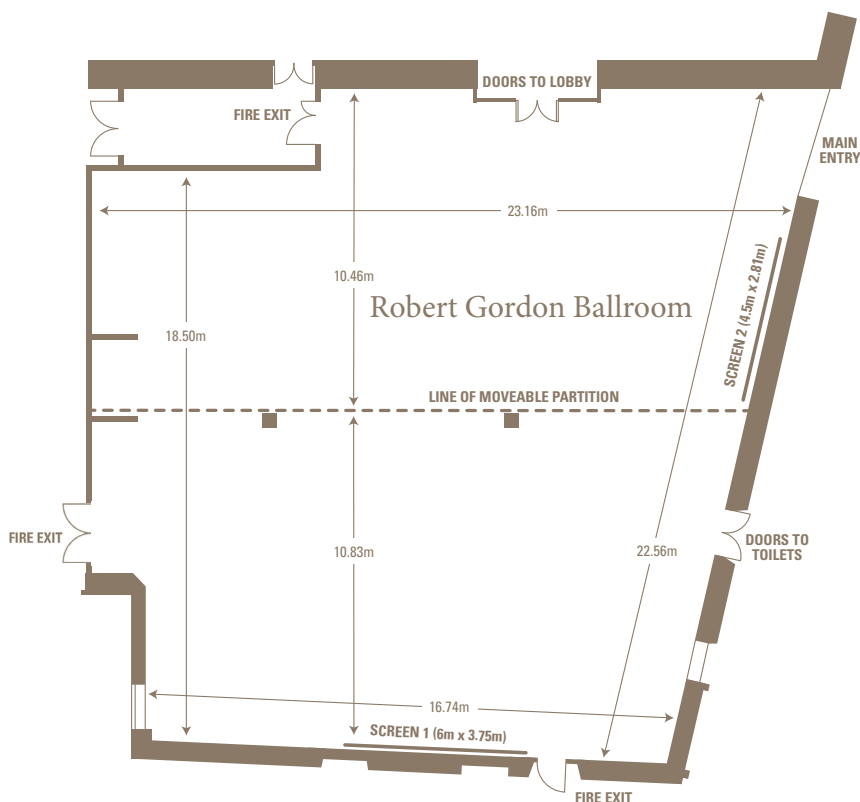

All capacity numbers are strictly guidelines. Maximum capacities will adjust based on additional tables, staging, dance floor and/or audio visual requirements.

Note: **Robert Gordon Ballroom** can be used as a whole room or split into two separate spaces. **Alberta** room can be used as a whole room or split into **Fort McMurray** and **Edmonton** rooms. **Maple** room can also be split for smaller groups.

